

Газовые плиты с газовой, электрической духовкой Diamante, Proху, индукционные плиты EcoKitchen, Falcon, Flex, Casa, вок-плиты Flex 5, Diamante, Eco Kitchen, Install

Технические характеристики

По вопросам продаж и поддержки обращайтесь:

Алматы (727)345-47-04
Ангарск (3955)60-70-56
Архангельск (8182)63-90-72
Астрахань (8512)99-46-04
Барнаул (3852)73-04-60
Белгород (4722)40-23-64
Благовещенск (4162)22-76-07
Брянск (4832)59-03-52
Владивосток (423)249-28-31
Владикавказ (8672)28-90-48
Владимир (4922)49-43-18
Волгоград (844)278-03-48
Вологда (8172)26-41-59
Воронеж (473)204-51-73
Екатеринбург (343)384-55-89

Иваново (4932)77-34-06
Ижевск (3412)26-03-58
Иркутск (395)279-98-46
Казань (843)206-01-48
Калининград (4012)72-03-81
Калуга (4842)92-23-67
Кемерово (3842)65-04-62
Киров (8332)68-02-04
Коломна (4966)23-41-49
Кострома (4942)77-07-48
Краснодар (861)203-40-90
Красноярск (391)204-63-61
Курск (4712)77-13-04
Курган (3522)50-90-47
Липецк (4742)52-20-81

Магнитогорск (3519)55-03-13
Москва (495)268-04-70
Мурманск (8152)59-64-93
Набережные Челны (8552)20-53-41
Нижегород (831)429-08-12
Новокузнецк (3843)20-46-81
Ноябрьск (3496)41-32-12
Новосибирск (383)227-86-73
Омск (3812)21-46-40
Орел (4862)44-53-42
Оренбург (3532)37-68-04
Пенза (8412)22-31-16
Петрозаводск (8142)55-98-37
Псков (8112)59-10-37
Пермь (342)205-81-47

Ростов-на-Дону (863)308-18-15
Рязань (4912)46-61-64
Самара (846)206-03-16
Санкт-Петербург (812)309-46-40
Саратов (845)249-38-78
Севастополь (8692)22-31-93
Саранск (8342)22-96-24
Симферополь (3652)67-13-56
Смоленск (4812)29-41-54
Сочи (862)225-72-31
Ставрополь (8652)20-65-13
Сургут (3462)77-98-35
Сыктывкар (8212)25-95-17
Тамбов (4752)50-40-97
Тверь (4822)63-31-35

Тольятти (8482)63-91-07
Томск (3822)98-41-53
Тула (4872)33-79-87
Тюмень (3452)66-21-18
Ульяновск (8422)24-23-59
Улан-Удэ (3012)59-97-51
Уфа (347)229-48-12
Хабаровск (4212)92-98-04
Чебоксары (8352)28-53-07
Челябинск (351)202-03-61
Череповец (8202)49-02-64
Чита (3022)38-34-83
Якутск (4112)23-90-97
Ярославль (4852)69-52-93

Россия +7(495)268-04-70

Казахстан +7(727)345-47-04

Беларусь +(375)257-127-884

Узбекистан +998(71)205-18-59

Киргизия +996(312)96-26-47

эл.почта: mhi@nt-rt.ru || сайт: <http://metos.nt-rt.ru/>

CODE: MG4343256

Gas range Metos Diamante D94/10TCTGSX
tabletop

ON ORDER



Technical specifications

Attachments

GENERAL

Description	Gas range Metos Diamante D94/10TCTGSX tabletop
-------------	--

DIMENSIONS AND CAPACITY

Item width mm	800
Item depth mm	900
Item height mm	250
Package volume	0.202 m3
Package dimensions (LxWxH)	85x95x25 cm
Net weight	125 kg
Package weight	135 kg

TECHNICAL INFORMATION

Gas diameter	1/2"
--------------	------

FEATURES

Raw material	stainless steel
Type	gas
Operation type	electromechanical
Top material type	cast iron
Model	Diamante

INSTALLATION

Installation	free standing
Installation	table model
Installation	fixed

ENERGY AND CONSUMPTION

Gas consumption kW	17.5
--------------------	------

Gas range with electric oven Metos Diamante D74/10CGE

Kaasutyyppi pitää määritellä tilausta tehdessä, koodi ei sisällä kahta eri suutinta, vaan toimittaja laittaa sen suuttimen joka ostotilauksella on pyydetty. ***** The type of gas must be specified when placing the order, the code does not include two different nozzles, but the supplier will install the nozzle requested in the purchase order. ***** Gastyp ska anges vid beställning, koden innehåller inte två olika munstycken utan leverantören kommer att installera munstycket som efterfrågas i beställningen.



Gas range with electric oven Metos Diamante D74/10CGE

Item width mm	800
Item depth mm	730
Item height mm	870
Package volume	0.566
Unit of volume	m3
Package volume	0.566 m3
Package length	82
Package width	75
Package height	92
Package unit of dimension	cm
Package dimensions (LxWxH)	82x75x92 cm
Net weight	135
Net weight	135 kg
Gross weight	135
Package weight	135 kg
Unit of weight	kg
Connection power kW	6
Connection voltage V	400
Frequency Hz	50/60
Gas diameter	1/2"
Gas consumption kW	18.2
Model	Diamante

CODE: MG4343228

Gas range with elrctric oven Metos Diamante D94/10CGE



Technical specifications

Attachments

GENERAL

Description	Gas range with elrctric oven Metos Diamante D94/10CGE
-------------	---

DIMENSIONS AND CAPACITY

Item width mm	800
Item depth mm	900
Item height mm	840
Package volume	0.759 m3
Package dimensions (LxWxH)	85x95x94 cm
Net weight	175 kg
Package weight	185 kg

TECHNICAL INFORMATION

Connection power kW	6
Connection voltage V	400
Frequency Hz	50/60
Type of electrical connection	Semifixed
Gas diameter	1/2"

FEATURES

Raw material	stainless steel
Type	gas
Operation type	electromechanical
Model	Diamante

ENERGY AND CONSUMPTION

Gas consumption kW	21.7
--------------------	------

CODE: MG4343234

Gas range with gas oven Metos Diamante D96/10CGG



Technical specifications

Attachments

GENERAL

Description	Gas range with gas oven Metos Diamante D96/10CGG
-------------	--

DIMENSIONS AND CAPACITY

Item width mm	1200
Item depth mm	900
Item height mm	840
Package volume	1.116 m3
Package dimensions (LxWxH)	125x95x94 cm
Net weight	250 kg
Package weight	260 kg

TECHNICAL INFORMATION

Gas diameter	1/2"
--------------	------

FEATURES

Raw material	stainless steel
Type	gas
Operation type	electromechanical
Model	Diamante

ENERGY AND CONSUMPTION

Gas consumption kW	40.2
--------------------	------

CODE: MG4343242

Gas range with gas oven Metos Diamante D98/10CGG



Technical specifications

Attachments

GENERAL

Description	Gas range with gas oven Metos Diamante D98/10CGG
-------------	--

DIMENSIONS AND CAPACITY

Item width mm	1600
Item depth mm	900
Item height mm	840
Package volume	1.473 m3
Package dimensions (LxWxH)	165x95x94 cm
Net weight	330 kg
Package weight	340 kg

TECHNICAL INFORMATION

Gas diameter	1/2"
--------------	------

FEATURES

Raw material	stainless steel
Type	gas
Operation type	electromechanical
Model	Diamante

ENERGY AND CONSUMPTION

Gas consumption kW	59.4
--------------------	------

CODE: MG4343262

Gas range Metos Diamante D96/10CTGDX with open cupboard



Technical specifications Attachments

GENERAL

Description	Gas range Metos Diamante D96/10CTGDX with open cupboard
-------------	---

DIMENSIONS AND CAPACITY

Item width mm	1200
Item depth mm	900
Item height mm	870
Package volume	1.152 m3
Package dimensions (LxWxH)	125x95x97 cm
Net weight	200 kg
Package weight	210 kg

TECHNICAL INFORMATION

Gas diameter	1/2"
--------------	------

FEATURES

Raw material	stainless steel
Type	gas
Operation type	electromechanical
Top material type	cast iron
Model	Diamante

INSTALLATION

Installation	fixed
Installation	floor model
Installation	free standing

ENERGY AND CONSUMPTION

Gas consumption kW	24.5
--------------------	------

CODE: MG4343272

Gas range Metos Diamante D94/10CTG with open cupboard



Technical specifications

Attachments

GENERAL

Description	Gas range Metos Diamante D94/10CTG with open cupboard
-------------	---

DIMENSIONS AND CAPACITY

Item width mm	800
Item depth mm	900
Item height mm	870
Package volume	0.783 m3
Package dimensions (LxWxH)	85x95x97 cm
Net weight	178 kg
Package weight	188 kg

TECHNICAL INFORMATION

Gas diameter	1/2"
--------------	------

FEATURES

Raw material	stainless steel
Type	gas
Operation type	electromechanical
Top material type	cast iron
Model	Diamante

INSTALLATION

Installation	fixed
Installation	floor model
Installation	free standing

ENERGY AND CONSUMPTION

Gas consumption kW	14
--------------------	----

CODE: MG4343818

Gas range with gas oven Metos Diamante D76/10CGGFL



Technical specifications

Attachments

GENERAL

Description	Gas range with gas oven Metos Diamante D76/10CGGFL
-------------	--

DIMENSIONS AND CAPACITY

Item width mm	1200
Item depth mm	730
Item height mm	870
Package volume	0.97 m3
Package dimensions (LxWxH)	125x80x97 cm
Net weight	182 kg
Package weight	192 kg

TECHNICAL INFORMATION

Gas diameter	1/2"
--------------	------

FEATURES

Type	gas
Model	Diamante

ENERGY AND CONSUMPTION

Gas consumption kW	37.3
--------------------	------

CODE: MG4343824

Gas range Metos Diamante D74/10CTGDX with open cupboard



Technical specifications

Attachments

GENERAL

Description	Gas range Metos Diamante D74/10CTGDX with open cupboard
-------------	---

DIMENSIONS AND CAPACITY

Item width mm	800
Item depth mm	730
Item height mm	870
Package volume	0.66 m3
Package dimensions (LxWxH)	85x80x97 cm
Net weight	170 kg
Package weight	175 kg

TECHNICAL INFORMATION

Gas diameter	1/2"
--------------	------

FEATURES

Type	gas
Model	Diamante

ENERGY AND CONSUMPTION

Gas consumption kW	15.1
--------------------	------

CODE: MG4343240

Gas range Metos Diamante D96/10TCG table top model



Technical specifications

Attachments

GENERAL

Description	Gas range Metos Diamante D96/10TCG table top model
-------------	--

DIMENSIONS AND CAPACITY

Item width mm	1200
Item depth mm	900
Item height mm	280
Package volume	0.451 m3
Package dimensions (LxWxH)	125x95x38 cm
Net weight	123 kg
Package weight	133 kg

TECHNICAL INFORMATION

Gas diameter	1/2"
--------------	------

FEATURES

Raw material	stainless steel
Type	gas
Operation type	electromechanical
Model	Diamante

INSTALLATION

Installation	free standing
Installation	table model
Installation	fixed

ENERGY AND CONSUMPTION

Gas consumption kW	32.2
--------------------	------

CODE: MG4343254

**Gas range Metos Diamante D94/10TCTGDX
tabletop**



Technical specifications

Attachments

GENERAL

Description	Gas range Metos Diamante D94/10TCTGDX tabletop
-------------	--

DIMENSIONS AND CAPACITY

Item width mm	800
Item depth mm	900
Item height mm	280
Package volume	0.307 m3
Package dimensions (LxWxH)	85x95x38 cm
Net weight	125 kg
Package weight	135 kg

TECHNICAL INFORMATION

Gas diameter	1/2"
--------------	------

FEATURES

Raw material	stainless steel
Type	gas
Operation type	electromechanical
Top material type	cast iron
Model	Diamante

INSTALLATION

Installation	free standing
Installation	table model
Installation	fixed

ENERGY AND CONSUMPTION

Gas consumption kW	17.5
--------------------	------

CODE: MG4343266

**Gas range Metos Diamante D96/10TCTGDX
tabletop**



Technical specifications

Attachments

GENERAL

Description	Gas range Metos Diamante D96/10TCTGDX tabletop
-------------	--

DIMENSIONS AND CAPACITY

Item width mm	1200
Item depth mm	900
Item height mm	280
Package volume	0.451 m3
Package dimensions (LxWxH)	125x95x38 cm
Net weight	200 kg
Package weight	210 kg

TECHNICAL INFORMATION

Gas diameter	1/2"
--------------	------

FEATURES

Raw material	stainless steel
Type	gas
Operation type	electromechanical
Top material type	cast iron
Model	Diamante

INSTALLATION

Installation	free standing
Installation	table model
Installation	fixed

ENERGY AND CONSUMPTION

Gas consumption kW	24.5
--------------------	------

CODE: MG4343812

Gas range Metos Diamante D76/10CG with open cupboard



Technical specifications

Attachments

GENERAL

Description	Gas range Metos Diamante D76/10CG with open cupboard
-------------	--

DIMENSIONS AND CAPACITY

Item width mm	1200
Item depth mm	730
Item height mm	870
Package volume	0.97 m3
Package dimensions (LxWxH)	125x80x97 cm
Net weight	105 kg
Package weight	115 kg

TECHNICAL INFORMATION

Gas diameter	1/2"
--------------	------

FEATURES

Type	gas
Model	Diamante

ENERGY AND CONSUMPTION

Gas consumption kW	27.3
--------------------	------

CODE: MG4343800

Gas range Metos Diamante D72/10CG with open cupboard



Technical specifications

Attachments

GENERAL

Description	Gas range Metos Diamante D72/10CG with open cupboard
-------------	--

DIMENSIONS AND CAPACITY

Item width mm	400
Item depth mm	730
Item height mm	870
Package volume	0.349 m3
Package dimensions (LxWxH)	45x80x97 cm
Net weight	50 kg
Package weight	60 kg

TECHNICAL INFORMATION

Gas diameter	1/2"
--------------	------

FEATURES

Type	gas
Model	Diamante

ENERGY AND CONSUMPTION

Gas consumption kW	9.1
--------------------	-----

CODE: MG4343832

Gas range Metos Diamante D74/10CTG with open cupboard



Technical specifications Attachments

GENERAL

Description	Gas range Metos Diamante D74/10CTG with open cupboard
-------------	---

DIMENSIONS AND CAPACITY

Item width mm	800
Item depth mm	730
Item height mm	870
Package volume	0.66 m3
Package dimensions (LxWxH)	85x80x97 cm
Net weight	125 kg
Package weight	135 kg

TECHNICAL INFORMATION

Gas diameter	1/2"
--------------	------

FEATURES

Type	gas
Model	Diamante

ENERGY AND CONSUMPTION

Gas consumption kW	12
--------------------	----

CODE: MG4343222

Gas range Metos Diamante D92/10TCG table top model



Technical specifications

Attachments

GENERAL

Description	Gas range Metos Diamante D92/10TCG table top model
-------------	--

DIMENSIONS AND CAPACITY

Item width mm	400
Item depth mm	900
Item height mm	280
Package volume	1.625 hl
Package dimensions (LxWxH)	45x95x38 cm
Net weight	46 kg
Package weight	56 kg

TECHNICAL INFORMATION

Gas diameter	1/2"
--------------	------

FEATURES

Raw material	stainless steel
Type	gas
Operation type	electromechanical
Model	Diamante

INSTALLATION

Installation	free standing
Installation	table model
Installation	fixed

ENERGY AND CONSUMPTION

Gas consumption kW	10.5
--------------------	------

CODE: MG4343232

Gas range Metos Diamante D96/10CG with open cupboard



Technical specifications

Attachments

GENERAL

Description	Gas range Metos Diamante D96/10CG with open cupboard
-------------	--

DIMENSIONS AND CAPACITY

Item width mm	1200
Item depth mm	900
Item height mm	900
Package volume	1.128 m3
Package dimensions (LxWxH)	125x95x95 cm
Net weight	157 kg
Package weight	167 kg

TECHNICAL INFORMATION

Gas diameter	1/2"
--------------	------

FEATURES

Raw material	stainless steel
Type	gas
Operation type	electromechanical
Model	Diamante

INSTALLATION

Installation	fixed
Installation	floor model
Installation	free standing

ENERGY AND CONSUMPTION

Gas consumption kW	32.2
--------------------	------

CODE: MG4343252

Gas range Metos Diamante D94/10CTGDX with open cupboard



Technical specifications

Attachments

GENERAL

Description	Gas range Metos Diamante D94/10CTGDX with open cupboard
-------------	---

DIMENSIONS AND CAPACITY

Item width mm	800
Item depth mm	900
Item height mm	870
Package volume	0.783 m3
Package dimensions (LxWxH)	85x95x97 cm
Net weight	175 kg
Package weight	185 kg

TECHNICAL INFORMATION

Gas diameter	1/2"
--------------	------

FEATURES

Raw material	stainless steel
Type	gas
Operation type	electromechanical
Top material type	cast iron
Model	Diamante

INSTALLATION

Installation	fixed
Installation	floor model
Installation	free standing

ENERGY AND CONSUMPTION

Gas consumption kW	17.5
--------------------	------

CODE: MG4343268

**Gas range Metos Diamante D96/10TCTGSX
tabletop**



Technical specifications

Attachments

GENERAL

Description	Gas range Metos Diamante D96/10TCTGSX tabletop
-------------	--

DIMENSIONS AND CAPACITY

Item width mm	1200
Item depth mm	900
Item height mm	280
Package volume	0.451 m3
Package dimensions (LxWxH)	125x95x38 cm
Net weight	200 kg
Package weight	210 kg

TECHNICAL INFORMATION

Gas diameter	1/2"
--------------	------

FEATURES

Raw material	stainless steel
Type	gas
Operation type	electromechanical
Top material type	cast iron
Model	Diamante

INSTALLATION

Installation	free standing
Installation	table model
Installation	fixed

ENERGY AND CONSUMPTION

Gas consumption kW	24.5
--------------------	------

CODE: MG4343820

Gas range Metos Diamante D76/10TCG table top model



Technical specifications

Attachments

GENERAL

Description	Gas range Metos Diamante D76/10TCG table top model
-------------	--

DIMENSIONS AND CAPACITY

Item width mm	1200
Item depth mm	730
Item height mm	280
Package volume	0.3 m3
Package dimensions (LxWxH)	125x80x30 cm
Net weight	70 kg
Package weight	80 kg

TECHNICAL INFORMATION

Gas diameter	1/2"
--------------	------

FEATURES

Type	gas
Model	Diamante

ENERGY AND CONSUMPTION

Gas consumption kW	27.3
--------------------	------

CODE: MG4343220

Gas range Metos Diamante D92/10CG with open cupboard



Technical specifications

Attachments

GENERAL

Description	Gas range Metos Diamante D92/10CG with open cupboard
-------------	--

DIMENSIONS AND CAPACITY

Item width mm	400
Item depth mm	900
Item height mm	900
Package volume	0.406 m3
Package dimensions (LxWxH)	45x95x95 cm
Net weight	70 kg
Package weight	80 kg

TECHNICAL INFORMATION

Gas diameter	1/2"
--------------	------

FEATURES

Raw material	stainless steel
Type	gas
Operation type	electromechanical
Model	Diamante

INSTALLATION

Installation	fixed
Installation	floor model
Installation	free standing

ENERGY AND CONSUMPTION

Gas consumption kW	10.5
--------------------	------

CODE: MG4343224

Gas range Metos Diamante D94/10CG with open cupboard



Technical specifications

Attachments

GENERAL

Description	Gas range Metos Diamante D94/10CG with open cupboard
-------------	--

DIMENSIONS AND CAPACITY

Item width mm	800
Item depth mm	900
Item height mm	900
Package volume	0.767 m3
Package dimensions (LxWxH)	85x95x95 cm
Net weight	116 kg
Package weight	126 kg

TECHNICAL INFORMATION

Gas diameter	1/2"
--------------	------

FEATURES

Raw material	stainless steel
Type	gas
Operation type	electromechanical
Model	Diamante

INSTALLATION

Installation	fixed
Installation	floor model
Installation	free standing

ENERGY AND CONSUMPTION

Gas consumption kW	21.7
--------------------	------

CODE: MG4343230

Gas range Metos Diamante D94/10TCG table top model



Technical specifications

Attachments

GENERAL

Description	Gas range Metos Diamante D94/10TCG table top model
-------------	--

DIMENSIONS AND CAPACITY

Item width mm	800
Item depth mm	900
Item height mm	280
Package volume	0.307 m3
Package dimensions (LxWxH)	85x95x38 cm
Net weight	88 kg
Package weight	98 kg

TECHNICAL INFORMATION

Gas diameter	1/2"
--------------	------

FEATURES

Raw material	stainless steel
Type	gas
Operation type	electromechanical
Model	Diamante

INSTALLATION

Installation	free standing
Installation	table model
Installation	fixed

ENERGY AND CONSUMPTION

Gas consumption kW	21.7
--------------------	------

CODE: MG4343238

Gas range with gas oven Metos Diamante D96/10CGFL



Technical specifications

Attachments

GENERAL

Description	Gas range with gas oven Metos Diamante D96/10CGFL
-------------	---

DIMENSIONS AND CAPACITY

Item width mm	1200
Item depth mm	900
Item height mm	900
Package volume	1.128 m3
Package dimensions (LxWxH)	125x95x95 cm
Net weight	248 kg
Package weight	258 kg

TECHNICAL INFORMATION

Gas diameter	1/2"
--------------	------

FEATURES

Raw material	stainless steel
Type	gas
Operation type	electromechanical
Model	Diamante

ENERGY AND CONSUMPTION

Gas consumption kW	44.3
--------------------	------

CODE: MG4343244

Gas range with gas oven Metos Diamante
D96/10CGFLR



Technical specifications

Attachments

GENERAL

Description	Gas range with gas oven Metos Diamante D96/10CGFLR
-------------	--

DIMENSIONS AND CAPACITY

Item width mm	1200
Item depth mm	900
Item height mm	870
Package volume	1.152 m3
Package dimensions (LxWxH)	125x95x97 cm
Net weight	248 kg
Package weight	258 kg

TECHNICAL INFORMATION

Connection power kW	4.5
Connection voltage V	400
Frequency Hz	50/60
Type of electrical connection	Semifixed
Gas diameter	1/2"

FEATURES

Raw material	stainless steel
Type	gas
Operation type	electromechanical
Model	Diamante

ENERGY AND CONSUMPTION

Gas consumption kW	44.3
--------------------	------

CODE: MG4343258

Gas range Metos Diamante D94/10CTGSX with open cupboard



Technical specifications

Attachments

GENERAL

Description	Gas range Metos Diamante D94/10CTGSX with open cupboard
-------------	---

DIMENSIONS AND CAPACITY

Item width mm	800
Item depth mm	900
Item height mm	870
Package volume	0.783 m3
Package dimensions (LxWxH)	85x95x97 cm
Net weight	175 kg
Package weight	185 kg

TECHNICAL INFORMATION

Gas diameter	1/2"
--------------	------

FEATURES

Raw material	stainless steel
Type	gas
Operation type	electromechanical
Top material type	cast iron
Model	Diamante

INSTALLATION

Installation	fixed
Installation	floor model
Installation	free standing

ENERGY AND CONSUMPTION

Gas consumption kW	17.5
--------------------	------

CODE: MG4343264

Gas range Metos Diamante D96/10CTGSX with open cupboard



Technical specifications Attachments

GENERAL

Description	Gas range Metos Diamante D96/10CTGSX with open cupboard
-------------	---

DIMENSIONS AND CAPACITY

Item width mm	1200
Item depth mm	900
Item height mm	870
Package volume	1.152 m3
Package dimensions (LxWxH)	125x95x97 cm
Net weight	200 kg
Package weight	210 kg

TECHNICAL INFORMATION

Gas diameter	1/2"
--------------	------

FEATURES

Raw material	stainless steel
Type	gas
Operation type	electromechanical
Top material type	cast iron
Model	Diamante

INSTALLATION

Installation	fixed
Installation	floor model
Installation	free standing

ENERGY AND CONSUMPTION

Gas consumption kW	24.5
--------------------	------

CODE: MG4343270

Gas range with gas oven Metos Diamante
D94/10CTGG



Technical specifications

Attachments

GENERAL

Description	Gas range with gas oven Metos Diamante D94/10CTGG
-------------	---

DIMENSIONS AND CAPACITY

Item width mm	800
Item depth mm	900
Item height mm	870
Package volume	0.783 m3
Package dimensions (LxWxH)	85x95x97 cm
Net weight	230 kg
Package weight	240 kg

TECHNICAL INFORMATION

Gas diameter	1/2"
--------------	------

FEATURES

Raw material	stainless steel
Type	gas
Operation type	electromechanical
Top material type	cast iron
Model	Diamante

ENERGY AND CONSUMPTION

Gas consumption kW	22
--------------------	----



CODE: MG4343804

Gas range Metos Diamante D74/10CG with open cupboard

Technical specifications Attachments

GENERAL

Description	Gas range Metos Diamante D74/10CG with open cupboard
-------------	--

DIMENSIONS AND CAPACITY

Item width mm	800
Item depth mm	730
Item height mm	870
Package volume	0.66 m3
Package dimensions (LxWxH)	85x80x97 cm
Net weight	80 kg
Package weight	90 kg

TECHNICAL INFORMATION

Gas diameter	1/2"
--------------	------

FEATURES

Type	gas
Model	Diamante

ENERGY AND CONSUMPTION

Gas consumption kW	18.2
--------------------	------

CODE: MG4343826

**Gas range Metos Diamante D74/10TCTGDX
tabletop**



Technical specifications

Attachments

GENERAL

Description	Gas range Metos Diamante D74/10TCTGDX tabletop
-------------	--

DIMENSIONS AND CAPACITY

Item width mm	800
Item depth mm	730
Item height mm	250
Package volume	0.204 m3
Package dimensions (LxWxH)	85x80x30 cm
Net weight	98 kg
Package weight	108 kg

TECHNICAL INFORMATION

Gas diameter	1/2"
--------------	------

FEATURES

Type	gas
Model	Diamante

ENERGY AND CONSUMPTION

Gas consumption kW	15,1
--------------------	------

CODE: MG4343226

Gas range with gas oven Metos Diamante D94/10CGG



Technical specifications

Attachments

GENERAL

Description	Gas range with gas oven Metos Diamante D94/10CGG
-------------	--

DIMENSIONS AND CAPACITY

Item width mm	800
Item depth mm	900
Item height mm	840
Package volume	0.759 m3
Package dimensions (LxWxH)	85x95x94 cm
Net weight	180 kg
Package weight	190 kg

TECHNICAL INFORMATION

Gas diameter	1/2"
--------------	------

FEATURES

Raw material	stainless steel
Type	gas
Operation type	electromechanical
Model	Diamante

ENERGY AND CONSUMPTION

Gas consumption kW	29.7
--------------------	------

CODE: MG4343236

Gas range with electric oven Metos Diamante D96/10CGE



Technical specifications

Attachments

GENERAL

Description	Gas range with electric oven Metos Diamante D96/10CGE
-------------	---

DIMENSIONS AND CAPACITY

Item width mm	1200
Item depth mm	900
Item height mm	840
Package volume	1.116 m3
Package dimensions (LxWxH)	125x95x94 cm
Net weight	245 kg
Package weight	255 kg

TECHNICAL INFORMATION

Connection power kW	6
Connection voltage V	400
Frequency Hz	50/60
Type of electrical connection	Semifixed
Gas diameter	1/2"

FEATURES

Raw material	stainless steel
Type	gas
Operation type	electromechanical
Model	Diamante

ENERGY AND CONSUMPTION

Gas consumption kW	32.2
--------------------	------

CODE: MG4343250

Gas range with gas oven Metos Diamante D94/10CTGGDX



Technical specifications

Attachments

GENERAL

Description	Gas range with gas oven Metos Diamante D94/10CTGGDX
-------------	---

DIMENSIONS AND CAPACITY

Item width mm	800
Item depth mm	900
Item height mm	870
Package volume	0.783 m3
Package dimensions (LxWxH)	85x95x97 cm
Net weight	225 kg
Package weight	235 kg

TECHNICAL INFORMATION

Gas diameter	1/2"
--------------	------

FEATURES

Raw material	stainless steel
Type	gas
Operation type	electromechanical
Top material type	cast iron
Model	Diamante

ENERGY AND CONSUMPTION

Gas consumption kW	25.8
--------------------	------

CODE: MG4343260

Gas range with gas oven Metos Diamante D96/10CTGGDX



Technical specifications

Attachments

GENERAL

Description	Gas range with gas oven Metos Diamante D96/10CTGGDX
-------------	---

DIMENSIONS AND CAPACITY

Item width mm	1200
Item depth mm	900
Item height mm	870
Package volume	1.152 m3
Package dimensions (LxWxH)	125x95x97 cm
Net weight	300 kg
Package weight	310 kg

TECHNICAL INFORMATION

Gas diameter	1/2"
--------------	------

FEATURES

Raw material	stainless steel
Type	gas
Operation type	electromechanical
Top material type	cast iron
Model	Diamante

ENERGY AND CONSUMPTION

Gas consumption kW	32.5
--------------------	------

CODE: MG4343274

Gas range Metos Diamante D94/10TCTG table top model



Technical specifications

Attachments

GENERAL

Description	Gas range Metos Diamante D94/10TCTG table top model
-------------	---

DIMENSIONS AND CAPACITY

Item width mm	800
Item depth mm	900
Item height mm	280
Package volume	0.307 m3
Package dimensions (LxWxH)	85x95x38 cm
Net weight	125 kg
Package weight	135 kg

TECHNICAL INFORMATION

Gas diameter	1/2"
--------------	------

FEATURES

Raw material	stainless steel
Type	gas
Operation type	electromechanical
Top material type	cast iron
Model	Diamante

INSTALLATION

Installation	free standing
Installation	table model
Installation	fixed

ENERGY AND CONSUMPTION

Gas consumption kW	14
--------------------	----

CODE: MG4343806

Gas range with gas oven Metos Diamante D74/10CGG



Technical specifications

Attachments

GENERAL

Description	Gas range with gas oven Metos Diamante D74/10CGG
-------------	--

DIMENSIONS AND CAPACITY

Item width mm	800
Item depth mm	730
Item height mm	870
Package volume	0.68 m3
Package dimensions (LxWxH)	85x80x100 cm
Net weight	140 kg
Package weight	140 kg

TECHNICAL INFORMATION

Gas diameter	1/2"
--------------	------

FEATURES

Type	gas
Model	Diamante

ENERGY AND CONSUMPTION

Gas consumption kW	26.2
--------------------	------

CODE: MG4343816

Gas range with electric oven Metos Diamante D76/10CGE



Technical specifications

Attachments

GENERAL

Description	Gas range with electric oven Metos Diamante D76/10CGE
-------------	---

DIMENSIONS AND CAPACITY

Item width mm	1200
Item depth mm	730
Item height mm	870
Package volume	0.842 m3
Package dimensions (LxWxH)	122x75x92 cm
Net weight	170 kg
Package weight	170 kg

TECHNICAL INFORMATION

Connection power kW	6
Connection voltage V	400
Frequency Hz	50/60
Type of electrical connection	Semifixed
Gas diameter	1/2"

FEATURES

Type	gas
Model	Diamante

ENERGY AND CONSUMPTION

Gas consumption kW	27.3
--------------------	------



CODE: MG4343834

Gas range Metos Diamante D74/10TCTG table top model

Technical specifications Attachments

GENERAL

Description	Gas range Metos Diamante D74/10TCTG table top model
-------------	---

DIMENSIONS AND CAPACITY

Item width mm	800
Item depth mm	730
Item height mm	250
Package volume	0.204 m3
Package dimensions (LxWxH)	85x80x30 cm
Net weight	98 kg
Package weight	108 kg

TECHNICAL INFORMATION

Gas diameter	1/2"
--------------	------

FEATURES

Type	gas
Model	Diamante

ENERGY AND CONSUMPTION

Gas consumption kW	12
--------------------	----

CODE: MG4243154

Gas range with gas oven Metos 8GHUBG/80

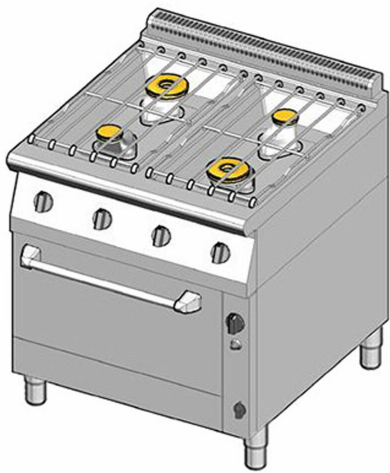

Technical specifications

GENERAL

Description	Gas range with gas oven Metos 8GHUBG/80
-------------	---

DIMENSIONS AND CAPACITY

Item width mm	800
Item depth mm	850
Item height mm	900
Package volume	0.855 m3
Package dimensions (LxWxH)	90x95x100 cm
Net weight	140 kg
Package weight	145 kg

FEATURES

Type	gas
------	-----

ENERGY AND CONSUMPTION

Gas consumption kW	27.1
--------------------	------

CODE: MG4243140

Gas range Metos 8GHUBO/40



Technical specifications

GENERAL

Description	Gas range Metos 8GHUBO/40
-------------	---------------------------

DIMENSIONS AND CAPACITY

Item width mm	400
Item depth mm	850
Item height mm	900
Package volume	0.475 m3
Package dimensions (LxWxH)	50x95x100 cm
Net weight	40 kg
Package weight	50 kg

FEATURES

Type	gas
------	-----

ENERGY AND CONSUMPTION

Gas consumption kW	10.5
--------------------	------

CODE: MG4243152

Gas range with electric oven Metos
8GHUBE/80

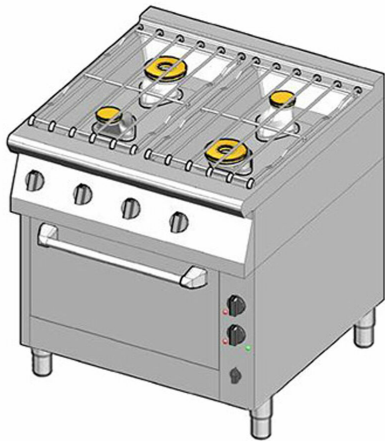

Technical specifications

Attachments

GENERAL

Description	Gas range with electric oven Metos 8GHUBE/80
-------------	--

DIMENSIONS AND CAPACITY

Item width mm	800
Item depth mm	850
Item height mm	900
Package volume	0.855 m3
Package dimensions (LxWxH)	90x95x100 cm
Net weight	135 kg
Package weight	140 kg

TECHNICAL INFORMATION

Connection power kW	5
Connection voltage V	400
Number of phases	3N
Type of electrical connection	Semifixed
Heat load sensitive W	5250
Heat load latent W	2100

FEATURES

Type	gas
------	-----

ENERGY AND CONSUMPTION

Gas consumption kW	21
--------------------	----

Gas range Metos 8GHUBO/80

Gas cooker in stainless steel with four burner: 2 x 3,5 kW + 2 x 7 kW. Pilot flame well protected against dirt and clogging to ensure stand-by function

- main gas shut-off cock integrated in the appliance
- ergonomic and well visible controls mounted on the control panel
- four control-knobs for gas valves
- open base unit



Gas range Metos 8GHUBO/80

Item width mm	800
Item depth mm	850
Item height mm	900
Package volume	0.855
Unit of volume	m3
Package volume	0.855 m3
Package length	90
Package width	95
Package height	100
Package unit of dimension	cm
Package dimensions (LxWxH)	90x95x100 cm
Net weight	65
Net weight	65 kg
Gross weight	75
Package weight	75 kg
Unit of weight	kg
Protection rating (IP)	X4
Gas diameter	3/4"
Gas consumption kW	21

Gas range Metos Proxy 74GCTT154

Gas range Metos Proxy 74GCTT154 with two burners total 15,4 kW.

- Gas range hobs with 7,7 kW (front) and 7,7 kW (back) burners
- Sturdy enamelled cast iron pan stands ensuring that they will last over time
- Stainless steel construction
- Top in AISI304 stainless steel with Scotch Brite finish moulded in a single piece to facilitate cleaning and prevent infiltrations of water and grime
- The gas connection is supplied in the front bottom part of the machine as standard
- Cast iron burners and burner caps, completely removable for an easy cleaning
- The gas hobs are designed with pilot flame, thermocouple and valved tap to ensure safety
- Ergonomic shape control panel with large knobs
- Stepless efficient control
- Standard h80 mm feet for flat-top installations to facilitate installation, connection and safe maintenance of the equipment

Accessories (separate price):

- JC joint cover - connection of the modules by means of a dedicated element to prevent infiltration of liquid and grime between the elements
- Door M40
- Neutral base M40
- Closing panel for technical cabinet- in-line cooking block
- Closing panel for technical cabinet- opposite cooking block
- Front plinth M40



Gas range Metos Proxy 74GCTT154

Item width mm	400
Item depth mm	700
Item height mm	295
Package volume	0.233
Unit of volume	m3
Package volume	0.233 m3
Package length	44
Package width	98
Package height	54
Package unit of dimension	cm
Package dimensions (LxWxH)	44x98x54 cm
Net weight	30
Net weight	30 kg
Gross weight	32
Package weight	32 kg
Unit of weight	kg
Remarks (gas)	Must be stated when ordering
Gas consumption kW	15.4
Model	Proxy

Gas range Metos Proxy

712GCTT382

Gas range Metos Proxy 712GCTT382 with six burners total 38,2 kW.

- Gas range hobs with 3x 5,7 kW (back) and 7,7 kW + 5,7 kW + 7,7 kW (front) burners
- Sturdy enamelled cast iron pan stands ensuring that they will last over time
- Stainless steel construction
- Top in AISI304 stainless steel with Scotch Brite finish moulded in a single piece to facilitate cleaning and prevent infiltrations of water and grime
- The gas connection is supplied in the front bottom part of the machine as standard
- Cast iron burners and burner caps, completely removable for an easy cleaning
- The gas hobs are designed with pilot flame, thermocouple and valved tap to ensure safety
- Ergonomic shape control panel with large knobs
- Stepless efficient control
- Standard h80 mm feet for flat-top installations to facilitate installation, connection and safe maintenance of the equipment

Accessories (separate price):

- JC joint cover - connection of the modules by means of a dedicated element to prevent infiltration of liquid and grime between the elements
- Door M40
- Neutral base M40
- Closing panel for technical cabinet- in-line cooking block
- Closing panel for technical cabinet- opposite cooking block
- Front plinth M40



Gas range Metos Proxy 712GCTT382

Item width mm	1200
Item depth mm	700
Item height mm	295
Package volume	0.54
Unit of volume	m3
Package volume	0.54 m3
Package length	125
Package width	80
Package height	54
Package unit of dimension	cm
Package dimensions (LxWxH)	125x80x54 cm
Net weight	90
Net weight	90 kg
Gross weight	100
Package weight	100 kg
Unit of weight	kg
Remarks (gas)	Must be stated when ordering
Gas consumption kW	38.2
Model	Proxy

Gas range Metos Proxy 712GCTT345

Gas range Metos Proxy 712GCTT345 with six burners total 34,5 kW.

- Gas range hobs with 3,85 kw + 5,7 kW + 3,85 kW(front) and 7,7 kW + 5,7 kW + 7,7 kW (back) burners
- Sturdy enamelled cast iron pan stands ensuring that they will last over time
- Stainless steel construction
- Top in AISI304 stainless steel with Scotch Brite finish moulded in a single piece to facilitate cleaning and prevent infiltrations of water and grime
- The gas connection is supplied in the front bottom part of the machine as standard
- Cast iron burners and burner caps, completely removable for an easy cleaning
- The gas hobs are designed with pilot flame, thermocouple and valved tap to ensure safety
- Ergonomic shape control panel with large knobs
- Stepless efficient control
- Standard h80 mm feet for flat-top installations to facilitate installation, connection and safe maintenance of the equipment

Accessories (separate price):

- JC joint cover - connection of the modules by means of a dedicated element to prevent infiltration of liquid and grime between the elements
- Door M40
- Neutral base M40
- Closing panel for technical cabinet- in-line cooking block
- Closing panel for technical cabinet- opposite cooking block
- Front plinth M40



Gas range Metos Proxy 712GCTT345

Item width mm	1200
Item depth mm	700
Item height mm	295
Package volume	0.54
Unit of volume	m3
Package volume	0.54 m3
Package length	125
Package width	80
Package height	54
Package unit of dimension	cm
Package dimensions (LxWxH)	125x80x54 cm
Net weight	90
Net weight	90 kg
Gross weight	100
Package weight	100 kg
Unit of weight	kg
Remarks (gas)	Must be stated when ordering
Gas consumption kW	34.5
Model	Proxy

Gas range Metos Proxy

712GCTT462

Gas range Metos Proxy 712GCTT462 with six burners total 46,2 kW.

- Gas range hobs with 6 x 7,7 kW burners
- Sturdy enamelled cast iron pan stands ensuring that they will last over time
- Stainless steel construction
- Top in AISI304 stainless steel with Scotch Brite finish moulded in a single piece to facilitate cleaning and prevent infiltrations of water and grime
- The gas connection is supplied in the front bottom part of the machine as standard
- Cast iron burners and burner caps, completely removable for an easy cleaning
- The gas hobs are designed with pilot flame, thermocouple and valved tap to ensure safety
- Ergonomic shape control panel with large knobs
- Stepless efficient control
- Standard h80 mm feet for flat-top installations to facilitate installation, connection and safe maintenance of the equipment

Accessories (separate price):

- JC joint cover - connection of the modules by means of a dedicated element to prevent infiltration of liquid and grime between the elements
- Door M40
- Neutral base M40
- Closing panel for technical cabinet- in-line cooking block
- Closing panel for technical cabinet- opposite cooking block
- Front plinth M40



Gas range Metos Proxy 712GCTT462

Item width mm	1200
Item depth mm	700
Item height mm	295
Package volume	0.54
Unit of volume	m3
Package volume	0.54 m3
Package length	125
Package width	80
Package height	54
Package unit of dimension	cm
Package dimensions (LxWxH)	125x80x54 cm
Net weight	90
Net weight	90 kg
Gross weight	100
Package weight	100 kg
Unit of weight	kg
Remarks (gas)	Must be stated when ordering
Gas consumption kW	46.2
Model	Proxy

Gas range Metos Proxy 78GCTT229

Gas range Metos Proxy 78GCTT229 with four burners total 22,95 kW.

- Gas range hobs with 5,7 kW + 7,7 kW(back) and 5,7 kW + 3,85kW (front) burners
- Sturdy enamelled cast iron pan stands ensuring that they will last over time
- Stainless steel construction
- Top in AISI304 stainless steel with Scotch Brite finish moulded in a single piece to facilitate cleaning and prevent infiltrations of water and grime
- The gas connection is supplied in the front bottom part of the machine as standard
- Cast iron burners and burner caps, completely removable for an easy cleaning
- The gas hobs are designed with pilot flame, thermocouple and valved tap to ensure safety
- Ergonomic shape control panel with large knobs
- Stepless efficient control
- Standard h80 mm feet for flat-top installations to facilitate installation, connection and safe maintenance of the equipment

Accessories (separate price):

- JC joint cover - connection of the modules by means of a dedicated element to prevent infiltration of liquid and grime between the elements
- Door M40
- Neutral base M40
- Closing panel for technical cabinet- in-line cooking block
- Closing panel for technical cabinet- opposite cooking block
- Front plinth M40



Gas range Metos Proxy 78GCTT229

Item width mm	800
Item depth mm	700
Item height mm	295
Package volume	0.413
Unit of volume	m3
Package volume	0.413 m3
Package length	78
Package width	98
Package height	54
Package unit of dimension	cm
Package dimensions (LxWxH)	78x98x54 cm
Net weight	60
Net weight	60 kg
Gross weight	70
Package weight	70 kg
Unit of weight	kg
Remarks (gas)	Must be stated when ordering
Gas consumption kW	22.95
Model	Proxy

Gas range Metos Proxy 78GCTT308

Gas range Metos Proxy 78GCTT308 with four burners total 30,8 kW.

- All gas range hobs with 7,7 kW burners (4pcs)
- Sturdy enamelled cast iron pan stands ensuring that they will last over time
- Stainless steel construction
- Top in AISI304 stainless steel with Scotch Brite finish moulded in a single piece to facilitate cleaning and prevent infiltrations of water and grime
- The gas connection is supplied in the front bottom part of the machine as standard
- Cast iron burners and burner caps, completely removable for an easy cleaning
- The gas hobs are designed with pilot flame, thermocouple and valved tap to ensure safety
- Ergonomic shape control panel with large knobs
- Stepless efficient control
- Standard h80 mm feet for flat-top installations to facilitate installation, connection and safe maintenance of the equipment

Accessories (separate price):

- JC joint cover - connection of the modules by means of a dedicated element to prevent infiltration of liquid and grime between the elements
- Door M40
- Neutral base M40
- Closing panel for technical cabinet- in-line cooking block
- Closing panel for technical cabinet- opposite cooking block
- Front plinth M40



Gas range Metos Proxy 78GCTT308

Item width mm	800
Item depth mm	700
Item height mm	295
Package volume	0.413
Unit of volume	m3
Package volume	0.413 m3
Package length	78
Package width	98
Package height	54
Package unit of dimension	cm
Package dimensions (LxWxH)	78x98x54 cm
Net weight	60
Net weight	60 kg
Gross weight	70
Package weight	70 kg
Unit of weight	kg
Remarks (gas)	Must be stated when ordering
Gas consumption kW	30.8
Model	Proxy

Gas range Metos Proxy 78GCTT308

Gas range Metos Proxy 78GCTT308 with four burners total 30,8 kW.

- All gas range hobs with 7,7 kW burners (4pcs)
- Sturdy enamelled cast iron pan stands ensuring that they will last over time
- Stainless steel construction
- Top in AISI304 stainless steel with Scotch Brite finish moulded in a single piece to facilitate cleaning and prevent infiltrations of water and grime
- The gas connection is supplied in the front bottom part of the machine as standard
- Cast iron burners and burner caps, completely removable for an easy cleaning
- The gas hobs are designed with pilot flame, thermocouple and valved tap to ensure safety
- Ergonomic shape control panel with large knobs
- Stepless efficient control
- Standard h80 mm feet for flat-top installations to facilitate installation, connection and safe maintenance of the equipment

Accessories (separate price):

- JC joint cover - connection of the modules by means of a dedicated element to prevent infiltration of liquid and grime between the elements
- Door M40
- Neutral base M40
- Closing panel for technical cabinet- in-line cooking block
- Closing panel for technical cabinet- opposite cooking block
- Front plinth M40



Gas range Metos Proxy 78GCTT308

Item width mm	800
Item depth mm	700
Item height mm	295
Package volume	0.413
Unit of volume	m3
Package volume	0.413 m3
Package length	78
Package width	98
Package height	54
Package unit of dimension	cm
Package dimensions (LxWxH)	78x98x54 cm
Net weight	60
Net weight	60 kg
Gross weight	70
Package weight	70 kg
Unit of weight	kg
Remarks (gas)	Must be stated when ordering
Gas consumption kW	30.8
Model	Proxy

Gas range Metos Proxy 74GCTT134

Gas range Metos Proxy 74GCTT134 with two burners total 13,4 kW.

- Gas range hobs with 7,7 kW (front) and 5,7 kW (back) burners
- Sturdy enamelled cast iron pan stands ensuring that they will last over time
- Stainless steel construction
- Top in AISI304 stainless steel with Scotch Brite finish moulded in a single piece to facilitate cleaning and prevent infiltrations of water and grime
- The gas connection is supplied in the front bottom part of the machine as standard
- Cast iron burners and burner caps, completely removable for an easy cleaning
- The gas hobs are designed with pilot flame, thermocouple and valved tap to ensure safety
- Ergonomic shape control panel with large knobs
- Stepless efficient control
- Standard h80 mm feet for flat-top installations to facilitate installation, connection and safe maintenance of the equipment

Accessories (separate price):

- JC joint cover - connection of the modules by means of a dedicated element to prevent infiltration of liquid and grime between the elements
- Door M40
- Neutral base M40
- Closing panel for technical cabinet- in-line cooking block
- Closing panel for technical cabinet- opposite cooking block
- Front plinth M40



Gas range Metos Proxy 74GCTT134

Item width mm	400
Item depth mm	700
Item height mm	295
Package volume	0.233
Unit of volume	m3
Package volume	0.233 m3
Package length	44
Package width	98
Package height	54
Package unit of dimension	cm
Package dimensions (LxWxH)	44x98x54 cm
Net weight	30
Net weight	30 kg
Gross weight	32
Package weight	32 kg
Unit of weight	kg
Remarks (gas)	Must be stated when ordering
Gas consumption kW	13.4
Model	Proxy

Gas range Metos Proxy

74GCTT115

Gas range Metos Proxy 74GCTT115 with two burners total 11,55 kW.

- Gas range hobs with 7,7 kW (back) and 3,85 kW (front) burners
- Sturdy enamelled cast iron pan stands ensuring that they will last over time
- Stainless steel construction
- Top in AISI304 stainless steel with Scotch Brite finish moulded in a single piece to facilitate cleaning and prevent infiltrations of water and grime
- The gas connection is supplied in the front bottom part of the machine as standard
- Cast iron burners and burner caps, completely removable for an easy cleaning
- The gas hobs are designed with pilot flame, thermocouple and valved tap to ensure safety
- Ergonomic shape control panel with large knobs
- Stepless efficient control
- Standard h80 mm feet for flat-top installations to facilitate installation, connection and safe maintenance of the equipment

Accessories (separate price):

- JC joint cover - connection of the modules by means of a dedicated element to prevent infiltration of liquid and grime between the elements
- Door M40
- Neutral base M40
- Closing panel for technical cabinet- in-line cooking block
- Closing panel for technical cabinet- opposite cooking block
- Front plinth M40



Gas range Metos Proxy 74GCTT115

Item width mm	400
Item depth mm	700
Item height mm	295
Package volume	0.233
Unit of volume	m3
Package volume	0.233 m3
Package length	44
Package width	98
Package height	54
Package unit of dimension	cm
Package dimensions (LxWxH)	44x98x54 cm
Net weight	30
Net weight	30 kg
Gross weight	32
Package weight	32 kg
Unit of weight	kg
Remarks (gas)	Must be stated when ordering
Gas consumption kW	11.55
Model	Proxy

Gas range Metos Proxy

78GCTT248

Gas range Metos Proxy 78GCTT248 with four burners total 24,8 kW.

- Gas range hobs with 5,7 kW + 5,7 kW(back) and 5,7 kW + 7,7 kW (front) burners
- Sturdy enamelled cast iron pan stands ensuring that they will last over time
- Stainless steel construction
- Top in AISI304 stainless steel with Scotch Brite finish moulded in a single piece to facilitate cleaning and prevent infiltrations of water and grime
- The gas connection is supplied in the front bottom part of the machine as standard
- Cast iron burners and burner caps, completely removable for an easy cleaning
- The gas hobs are designed with pilot flame, thermocouple and valved tap to ensure safety
- Ergonomic shape control panel with large knobs
- Stepless efficient control
- Standard h80 mm feet for flat-top installations to facilitate installation, connection and safe maintenance of the equipment

Accessories (separate price):

- JC joint cover - connection of the modules by means of a dedicated element to prevent infiltration of liquid and grime between the elements
- Door M40
- Neutral base M40
- Closing panel for technical cabinet- in-line cooking block
- Closing panel for technical cabinet- opposite cooking block
- Front plinth M40



Gas range Metos Proxy 78GCTT248

Item width mm	800
Item depth mm	700
Item height mm	295
Package volume	0.413
Unit of volume	m3
Package volume	0.413 m3
Package length	78
Package width	98
Package height	54
Package unit of dimension	cm
Package dimensions (LxWxH)	78x98x54 cm
Net weight	60
Net weight	60 kg
Gross weight	70
Package weight	70 kg
Unit of weight	kg
Remarks (gas)	Must be stated when ordering
Gas consumption kW	24.8
Model	Proxy

Gas range Metos Diamante D74/10TCG table top model

The tabletop Metos Diamante D74/10TCG gas stove has four sturdy nickel-plated burners. The burners are equipped with a two-part flame spreader that divides the flame into two different zones. In this way, the heat spreads over a wider area, giving the bottom of the pot a more even heat. It is easy to place a smaller pot or pan on the acid-resistant, cast-iron, black-enameled potholders. The rear 3.5 kW burners are for Ø150-300 mm boilers, the front 5.6 kW burners for Ø150-380 mm boilers.

The stainless steel body of the device and the removable basins made of stainless steel under the burners make cleaning easy. The venturi burners are installed vertically, preventing clogging of the nozzles and the accumulation of dirt. The gas stove works with piezo ignition. Gas burners are equipped with flame arresters that prevent gas from entering the flameless device.

Sturdy, stylish and hygienic Metos Diamante 70 restaurant equipment series has been designed down to every detail as an efficient and functional solution, from pre-treatment to the preparation of the food itself, without forgetting its easy cleaning. The Diamante 70 series devices are available as a table model or on their own stand, individually or in a combination of several devices, from small to medium-sized or large kitchens. The surfaces of the appliances are laser cut, which guarantees that the appliances can be combined into a neat, cohesive island or a line for conditions that require heavy use and will stand the eye even in an open kitchen.

- table model
- four burners 2x3.5kW



and 2x5.6kW

- vertically mounted burners with flame spreaders
- removable basins under the burners
- large controls are protected from splashes
- stainless steel frame
- overheating protection
- piezo ignition
- flame arrester in the burners

DELIVERY INCLUDES:

- natural gas or liquid gas nozzle

ACCESSORIES (to be ordered separately):

- two-burner, flat, cast-iron frying pan
- two-burner, grooved, cast-iron frying pan
- open platform
- stand with wires
- pedestal doors
- pedestal doors for equipment racks
- equipment racks; knife -, utensil - and spice holder, spice jar holder
- drawer on the stand
- thermal base for the stand
- plinth and side panels and 2x5.6kW
- vertically mounted burners with flame spreaders
- removable basins under the burners
- large controls are protected from splashes
- stainless steel frame
- overheating protection
- piezo ignition
- flame arrester in the burners

DELIVERY INCLUDES:

- natural gas or liquid gas nozzle

ACCESSORIES (to be ordered separately):

- two-burner, flat, cast-iron frying pan
- two-burner, grooved, cast-iron frying pan
- open platform
- stand with wires
- pedestal doors
- pedestal doors for equipment racks
- equipment racks; knife -, utensil - and spice holder, spice jar holder
- drawer on the stand
- thermal base for the stand
- plinth and side panels

Gas range Metos Diamante D74/10TCG table top model

Item width mm	800
Item depth mm	730
Item height mm	280
Package volume	0.204
Unit of volume	m3
Package volume	0.204 m3
Package length	85
Package width	80
Package height	30
Package unit of dimension	cm
Package dimensions (LxWxH)	85x80x30 cm
Net weight	53
Net weight	53 kg
Gross weight	63
Package weight	63 kg
Unit of weight	kg
Gas diameter	1/2"
Gas consumption kW	18.2
Model	Diamante

CODE: MG4343802

Gas range Metos Diamante D72/10TCG table top model



Technical specifications

Attachments

GENERAL

Description	Gas range Metos Diamante D72/10TCG table top model
-------------	--

DIMENSIONS AND CAPACITY

Item width mm	400
Item depth mm	730
Item height mm	280
Package volume	0.108 m3
Package dimensions (LxWxH)	45x80x30 cm
Net weight	33 kg
Package weight	43 kg

TECHNICAL INFORMATION

Gas diameter	1/2"
--------------	------

FEATURES

Type	gas
Model	Diamante

ENERGY AND CONSUMPTION

Gas consumption kW	9,1
--------------------	-----

Induction range OI64E

1 electric plates 5 kW Ø 220 mm.



Induction range OI64E

Item width mm	400
Item depth mm	650
Item height mm	295
Package volume	0.01
Unit of volume	m3
Package volume	0.01 m3
Package length	0
Package width	0
Package height	0
Package unit of dimension	cm
Package dimensions (LxWxH)	0x0x0 cm
Net weight	18
Net weight	18 kg
Gross weight	20
Package weight	20 kg
Unit of weight	kg
Connection power kW	5
Connection voltage V	400
Number of phases	3N
Frequency Hz	50
Type of electrical connection	Semifixed

Induction range Metos Eco Kitchen IND-10PH-5000

Table top induction range. Stainless steel casing

- Schott ceramic glass cooking surface: 320 x 320 mm
- step-less regulation
- simple to use- only one knob to turn
- overheating protection
- Cooking area diameter 120-230 mm
- pilot light
- plug



Induction range Metos Eco Kitchen IND-10PH-5000

Item width mm	360
Item depth mm	450
Item height mm	185
Package volume	0.107
Unit of volume	m3
Package volume	0.107 m3
Package length	59
Package width	47
Package height	38.5
Package unit of dimension	cm
Package dimensions (LxWxH)	59x47x38.5 cm
Net weight	12
Net weight	12 kg
Gross weight	14
Package weight	14 kg
Unit of weight	kg
Connection power kW	5
Fuse Size A	7
Connection voltage V	400
Number of phases	3N
Frequency Hz	50
Protection rating (IP)	X3
Type of electrical connection	Semifixed
Power type	electric
Type	induction
Operation type	electromechanical
Top material type	ceramic
Cooking zone	1
Cooking zone size mm	320x320

Induction range Metos Eco Kitchen IND-10PH-5000

Cooking zone power kW	5
Power range kW	5
Frying top type	smooth

Induction range Metos Eco Kitchen IND-10P-3500

stainless steel casing schott ceramic glass cooking surface:
320 x 320 mm step-less regulation simple to use- only one
knob to turn overheating protection Cooking area diameter
120-230 mm pilot light Plug



Induction range Metos Eco Kitchen IND-10P-3500

Item width mm	360
Item depth mm	440
Item height mm	185
Package volume	0.105
Unit of volume	m3
Package volume	0.105 m3
Package length	59
Package width	47
Package height	38
Package unit of dimension	cm
Package dimensions (LxWxH)	59x47x38 cm
Net weight	11
Net weight	11 kg
Gross weight	13
Package weight	13 kg
Unit of weight	kg
Connection power kW	3.5
Fuse Size A	15
Connection voltage V	230
Number of phases	1N
Frequency Hz	50
Protection rating (IP)	X3
Type of electrical connection	Plug
Power type	electric
Type	induction
Operation type	electromechanical
Top material type	ceramic
Cooking zone	1
Cooking zone size mm	320x320

Induction range Metos Eco Kitchen IND-10P-3500

Cooking zone power kW	3.5
Power range kW	3.5
Frying top type	smooth

Induction range Metos

Multizone Ardox IE4 8 x 3,5 kW

Induction range multizone, 8 x 3,5 kW Dimensions of the ceramic surface 650 X 650 mm Made completely out of stainless steel. On an open stand with a stainless steel shelf.

Fast, efficient and safe.

- Induction range produces virtually no excess heat to the kitchen
- Considerably faster than an electric or gas range
- Immediate reaction to power adjustment
- The range itself does not warm up and is always cooler than the cooking vessel
- Spill-overs do not burn in the cool surfaces
- Heat is produced only when a cooking vessel with min diam. 120mm is on the zone
- Energy consumption significantly lower than that of an electric range

Because of the operating principle, the cooking vessels used must have a magnetic bottom. Best results can be achieved with steel vessels with either sandwich or compound bottom. Most cast iron cooking vessels work. Aluminium vessels are not recommended and they usually do not work.



Induction range Metos Multizone Ardox IE4 8 x 3,5 kW

Item width mm	800
Item depth mm	800
Item height mm	900
Package volume	0.831
Unit of volume	m3
Package volume	0.831 m3
Package length	86
Package width	92
Package height	105
Package unit of dimension	cm
Package dimensions (LxWxH)	86x92x105 cm
Net weight	60
Net weight	60 kg
Gross weight	95
Package weight	95 kg
Unit of weight	kg
Connection power kW	28
Fuse Size A	50
Connection voltage V	400
Number of phases	3PE
Frequency Hz	50/60
Startup current A	43
Protection rating (IP)	X3
Type of electrical connection	Fixed
Remarks (electrical)	8 x 3,5 kW
Power type	electric
Type	induction
Operation type	electromechanical
Top material type	ceramic

Induction range Metos Multizone Ardox IE4 8 x 3,5 kW

Cooking zone	4
Frying top type	smooth

Induction range Metos EcoKitchen IND-E0P- L5000x4U

Free standing induction range. Stainless steel construction

- Schott ceramic glass surface: 650 x 650 mm
- 4 coils, each 5 kW
- Step-less regulation, 4 separate knobs
- Overheating protection
- Cooking area diameter 120-230 mm



Induction range Metos EcoKitchen IND-E0P-L5000x4U

Item width mm	800
Item depth mm	800
Item height mm	900
Package volume	0.936
Unit of volume	m3
Package volume	0.936 m3
Package length	91
Package width	91
Package height	113
Package unit of dimension	cm
Package dimensions (LxWxH)	91x91x113 cm
Net weight	82
Net weight	82 kg
Gross weight	123
Package weight	123 kg
Unit of weight	kg
Connection power kW	20
Fuse Size A	32
Connection voltage V	400
Number of phases	3NPE
Frequency Hz	50
Protection rating (IP)	X4
Type of electrical connection	Semifixed
Power type	electric
Type	induction
Operation type	electromechanical
Top material type	ceramic
Cooking zone	4
Cooking zone size mm	230

Induction range Metos EcoKitchen IND-E0P-L5000x4U

Cooking zone power kW	5
Power range kW	20
Frying top type	smooth

Induction range Metos EcoKitchen IND-E0P- L3500x2U

Free standing induction range stainless steel construction
schott ceramic glass surface: 320 x 650 mm 2 coils: diameter
230 mm, each 3.5 kW Cooking area diameter 120-230 mm
step-less regulation, 2 separate knobs overheating protection
miminum pot diameter 120mm



Induction range Metos EcoKitchen IND-E0P-L3500x2U

Item width mm	400
Item depth mm	800/850
Item height mm	900
Package volume	0.524
Unit of volume	m3
Package volume	0.524 m3
Package length	91
Package width	51
Package height	113
Package unit of dimension	cm
Package dimensions (LxWxH)	91x51x113 cm
Net weight	39
Net weight	39 kg
Gross weight	70
Package weight	70 kg
Unit of weight	kg
Connection power kW	7
Fuse Size A	16
Connection voltage V	400
Number of phases	3N
Frequency Hz	50
Protection rating (IP)	X3
Type of electrical connection	Semifixed
Power type	electric
Type	induction
Operation type	electromechanical
Top material type	ceramic
Cooking zone	2
Cooking zone size mm	230

Induction range Metos EcoKitchen IND-E0P-L3500x2U

Cooking zone power kW	3.5
Power range kW	7
Frying top type	smooth

Induction range Metos Diamante D74/10TCII table top model, 14

The induction table top model Metos Diamante D74/10TCII has four ceramic Ø230 mm size 3,5 kW cooking zones. .Cooking zones - in which the temperature can be regulated via control knobs - have been marked on the hob made of unbreakable ceramic glass. An induction range works by only transferring inductive heat from the hob directly to the cooking vessel. Heat does not accumulate within the hob; only the bottom of the pot and the food in the pot or vessel warms up. The hob around the vessels remains cold, which makes using an induction range fast and safe. Cleaning is also easy, since food does not burn onto a cold hob.



Every detail of the strong, stylish and hygienic restaurant range series Metos Diamante 70 has been planned as an efficient and functioning solution, from pre-treatment to the preparation of the food itself, without forgetting the need to easily clean the range. Diamante 70 series ranges are available as a table top model as well as with its own cupboard, as single or multiple combined units, and are suitable for use in small to mid-sized to large kitchens. Laser cut range working surfaces allow for the seamless joining together of units into cleanly connected islands or lines in places of heavy use, such as large kitchens.

- four Ø230 mm cooking zones (3.5 kW / cooking zone)
- table model
- large splash proof control knobs
- the exterior and feet are made from stainless steel
- overheating protection

EXTRA ACCESSORIES (can be ordered separately):

- open stand
- cupboard doors

Induction range Metos Diamante D74/10TCII table top model, 14

Item width mm	800
Item depth mm	730
Item height mm	250
Package volume	1.912
Unit of volume	m3
Package volume	1.912 m3
Package length	85
Package width	75
Package height	30
Package unit of dimension	cm
Package dimensions (LxWxH)	85x75x30 cm
Net weight	57
Net weight	57 kg
Gross weight	67
Package weight	67 kg
Unit of weight	kg
Connection power kW	14
Connection voltage V	400
Number of phases	3NPE
Frequency Hz	50/60
Protection rating (IP)	X4
Model	Diamante

Induction range Metos Diamante D72/10TCII table top model, 10

The induction range Metos Diamante D72/10TCII has two ceramic Ø230 mm size 5 kW cooking zones. The cooking plate made of unbreakable ceramic glass, which temperature can be adjusted from the adjustor knobs that have twelve level settings.

When operating the induction stove, the ceramic table top frame does not heat up and the only heat exerted comes from the cooking dish used. Moreover, heat does not collect into or around the stove, only the bottom of the pan and the food inside the pan or dish heat up. Therefore, using an induction stove is quick and safe. In addition, the cleaning of the stove is also easy, as food will not burn onto the cool surface.

Every detail of the strong, stylish and hygienic restaurant range series Metos Diamante 70 has been planned as an efficient and functioning solution, from pre-treatment to the preparation of the food itself, without forgetting the need to easily clean the range. Diamante 70 series ranges are available as a table top model as well as with its own cupboard, as single or multiple combined units, and are suitable for use in small to mid-sized to large kitchens. Laser cut range working surfaces allow for the seamless joining together of units into cleanly connected islands or lines in places of heavy use, such as large kitchens.

- two Ø230 mm cooking zones (5 kW / cooking zone)
- table top model
- large splash proof control knobs
- power adjustable on 12 levels
- the exterior and feet are made of stainless steel
- circular display identifies each cooking area
- with



sensor to detect pot or pan on surface top

- overheating protection

EXTRA ACCESSORIES (can be ordered separately):

- open stand sensor to detect pot or pan on surface top
- overheating protection

EXTRA ACCESSORIES (can be ordered separately):

- open stand

Induction range Metos Diamante D72/10TCII table top model, 10

Item width mm	400
Item depth mm	730
Item height mm	250
Package volume	0.108
Unit of volume	m3
Package volume	0.108 m3
Package length	45
Package width	80
Package height	30
Package unit of dimension	cm
Package dimensions (LxWxH)	45x80x30 cm
Net weight	35
Net weight	35 kg
Gross weight	40
Package weight	40 kg
Unit of weight	kg
Connection power kW	10
Connection voltage V	400
Number of phases	3NPE
Frequency Hz	50/60
Model	Diamante

Induction range Metos

Diamante D94/10TCII table top model

The Metos Diamante D94/10TCII table model induction stove has four 5kW cooking plates. The cooking plates, which temperature can be adjusted from the adjustor knobs that have twelve level settings.

When operating the induction stove, the ceramic table top frame does not heat up and the only heat exerted comes from the cooking dish used. Moreover, heat does not collect into or around the stove, only the bottom of the pan and the food inside the pan or dish heat up. Therefore, using an induction stove is quick and safe. In addition, the cleaning of the stove is also easy, as food will not burn onto the cool surface.

The Metos Diamante 90 -restaurant series is designed for demanding use in professional kitchens and, thus, the appliances are extremely efficient, functional and stylish. The sturdy structure, straightforward use and easy cleanability enable more focus on preparing the food itself. The Diamante 90 -series appliances are available in either a table top version or with its own stand, individually or in combination with other appliances. The appliances are laser cut, which guarantees that they can be connected to other appliances to form a clean and stylish look.

- table top model
- four cooking plates (5 kW / cooking plate)
- circular display identifies each cooking area
- large adjustors protected from splashes, 12 levels
- frame made of stainless steel
- with sensor to detect pot or pan on surface top
- overheating protection



Induction range Metos Diamante D94/10TCII table top model

Item width mm	800
Item depth mm	900
Item height mm	250
Package volume	0.299
Unit of volume	m3
Package volume	0.299 m3
Package length	85
Package width	95
Package height	37
Package unit of dimension	cm
Package dimensions (LxWxH)	85x95x37 cm
Net weight	132
Net weight	132 kg
Gross weight	142
Package weight	142 kg
Unit of weight	kg
Connection power kW	20
Connection voltage V	400
Number of phases	3NPE
Frequency Hz	50/60

Induction range Metos Diamante D92/10GCII with open cupboard

The Metos Diamante D92/10GCII induction stove with a stand has two 5kW cooking plates. The cooking plates, which temperature can be adjusted from the adjustor knobs that have twelve level settings.

When operating the induction stove, the ceramic table top frame does not heat up and the only heat exerted comes from the cooking dish used. Moreover, heat does not collect into or around the stove, only the bottom of the pan and the food inside the pan or dish heat up. Therefore, using an induction stove is quick and safe. In addition, the cleaning of the stove is also easy, as food will not burn onto the cool surface.

The Metos Diamante 90 -restaurant series is designed for demanding use in professional kitchens and, thus, the appliances are extremely efficient, functional and stylish. The sturdy structure, straightforward use and easy cleanability enable more focus on preparing the food itself. The Diamante 90 -series appliances are available in either a table top version or with its own stand, individually or in combination with other appliances. The appliances are laser cut, which guarantees that they can be connected to other appliances to form a clean and stylish look.

- open stand, height 850...920 mm
- two cooking plates (5 kW / cooking plate)
- circular display identifies each cooking area
- large adjustors protected from splashes, 12 levels
- frame made of stainless steel
- with sensor to detect pot or pan on surface top
- overheating protection

ADDITIONAL ACCESSORIES (order separately):

-



Induction range Metos Diamante D92/10GCII with open cupboard

Item width mm	400
Item depth mm	900
Item height mm	870
Package volume	0.419
Unit of volume	m3
Package volume	0.419 m3
Package length	45
Package width	95
Package height	98
Package unit of dimension	cm
Package dimensions (LxWxH)	45x95x98 cm
Net weight	85
Net weight	85 kg
Gross weight	95
Package weight	95 kg
Unit of weight	kg
Connection power kW	10
Connection voltage V	400
Number of phases	3NPE
Frequency Hz	50/60
Protection rating (IP)	X4

Induction range Metos

Diamante D74/10TCII table top model, 20kW

The induction wok table top model Metos Diamante 70 D74/10TCII has four ceramic Ø230 mm size 5 kW cooking zones. Cooking zones - in which the temperature can be regulated via control knobs - have been marked on the 6mm thick hob made of unbreakable ceramic glass. An induction range works by only transferring inductive heat from the hob directly to the cooking vessel. Heat does not accumulate within the hob; only the bottom of the pot and the food in the pot or vessel warms up. The hob around the vessels remains cold, which makes using an induction range fast and safe. Cleaning is also easy, since food does not burn onto a cold hob. In addition, the rear of the range is at an incline, which prevents splashes from flowing behind the range.



Every detail of the strong, stylish and hygienic restaurant range series Metos Diamante 70 has been planned as an efficient and functioning solution, from pre-treatment to the preparation of the food itself, without forgetting the need to easily clean the range. Diamante 70 series ranges are available as a table top model as well as with its own cupboard, as single or multiple combined units, and are suitable for use in small to mid-sized to large kitchens. Laser cut range working surfaces allow for the seamless joining together of units into cleanly connected islands or lines in places of heavy use, such as large kitchens.

- four Ø230 mm cooking zones (5 kW / cooking zone)
- table model
- large splash proof control knobs
- the exterior and feet are made from stainless steel
- overheating protection

EXTRA ACCESSORIES (can be ordered separately):

- open stand
- stand with guide rails
- cupboard doors;
- cupboard doors for utensil frames;
- utensil frames; knife rack, utensil rack, spice rack frame, spice jar rack;
- drawer for the cupboard;
- cupboard with a heated bottom;
- socket;
- side panels.

EXTRA ACCESSORIES (can be ordered separately):

- open stand
- stand with guide rails
- cupboard doors;
- cupboard doors for utensil frames;
- utensil frames; knife rack, utensil rack, spice rack frame, spice jar rack;
- drawer for the cupboard;
- cupboard with a heated bottom;
- socket;
- side panels.

Induction range Metos Diamante D74/10TCII table top model, 20kW

Item width mm	800
Item depth mm	730
Item height mm	250
Package volume	1.912
Unit of volume	m3
Package volume	1.912 m3
Package length	85
Package width	75
Package height	30
Package unit of dimension	cm
Package dimensions (LxWxH)	85x75x30 cm
Net weight	57
Net weight	57 kg
Gross weight	67
Package weight	67 kg
Unit of weight	kg
Connection power kW	20
Connection voltage V	400
Frequency Hz	50/60
Model	Diamante

Induction range Metos

Diamante D74/10GCII

4x5kW

The Metos Diamante 70 D74/10GCII 20kW induction range has four Ø230 mm size 5 kW cooking zones. Cooking zones - in which the temperature can be regulated via control knobs - have been marked on the 6mm thick hob made of unbreakable ceramic glass. An induction range works by only transferring inductive heat from the hob directly to the cooking vessel. Heat does not accumulate within the hob; only the bottom of the pot and the food in the pot or vessel warms up. The hob around the vessels remains cold, which makes using an induction range fast and safe. Cleaning is also easy, since food does not burn onto a cold hob. In addition, the rear of the range is at an incline, which prevents splashes from flowing behind the range.

- Four Ø230 mm cooking zones (5 kW / cooking zone)
- Large splash proof control knobs
- The exterior and feet are made from stainless steel
- Adjustable height 840...900 mm
- Overheating protection



Induction range Metos Diamante D74/10GCII 4x5kW

Item width mm	800
Item depth mm	730
Item height mm	870
Package volume	0.508
Unit of volume	m3
Package volume	0.508 m3
Package length	80
Package width	73
Package height	87
Package unit of dimension	cm
Package dimensions (LxWxH)	80x73x87 cm
Net weight	80
Net weight	80 kg
Gross weight	90
Package weight	90 kg
Unit of weight	kg
Connection power kW	20
Connection voltage V	400
Number of phases	3NPE
Frequency Hz	50/60
Model	Diamante

Induction range with convection oven Metos Falcon E3913i 400

Induction range with 4 induction cooking zones with convection oven.

Range:

- 4 x round zone 270mm á 3,5 kW.
- in-built pan detection
- 10 step power regulation.
- 6 mm thick glass ceramic working top
- entirely made of stainless steel.

Oven:

- fan assisted GN 1/1 size oven
- 5 pairs of U shape grids, pitch is 62 mm
- cooking cabinet, door and external surfaces stainless steel
- temperature: +100 - 270°C
- glass panels in oven doors
- 2 grids 530 x 500 mm included

Optional extras:

- additional grids 530x500 mm



Induction range with convection oven Metos Falcon E3913i 400

Product capacity	4 cooking zones, oven 2xGN1/1
Item width mm	900
Item depth mm	870
Item height mm	900
Package volume	0.831
Unit of volume	m3
Package volume	0.831 m3
Package length	95
Package width	100
Package height	100
Package unit of dimension	cm
Package dimensions (LxWxH)	95x100x100 cm
Net weight	140
Net weight	140 kg
Gross weight	160
Package weight	160 kg
Unit of weight	kg
Connection power kW	20
Fuse Size A	32
Connection voltage V	400
Number of phases	3NPE
Frequency Hz	50
Protection rating (IP)	IPX3
Type of electrical connection	Semifixed



METOS FALCON

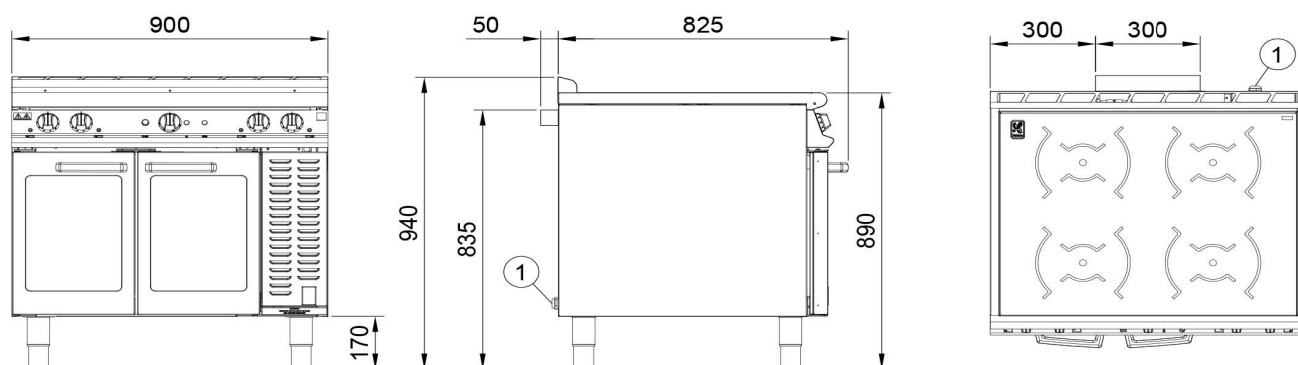

This document may not be copied in part or in whole by any process nor passed on to a third party without the written permission of the owner Metos Oy Ab.

Induction range with convection oven Metos Falcon E3914i 400

Induction range with 4 induction cooking zones with convection oven.

Range:

- 4 x round zone 270mm á 5 kW.
- in-built pan detection
- 10 step power regulation.
- 6 mm thick glass ceramic working top
- entirely made of stainless steel.

Oven:

- fan assisted GN 1/1 size oven
- 5 pairs of U shape grids, pitch is 62 mm
- cooking cabinet, door and external surfaces stainless steel
- temperature: +100 - 270°C
- glass panels in oven doors
- 2 grids 530 x 500 mm included

Optional extras:

- additional grids 530x500 mm



Induction range with convection oven Metos Falcon E3914i 400

Product capacity	4 cooking zones, oven 2xGN1/1
Item width mm	900
Item depth mm	870
Item height mm	900
Package volume	0.831
Unit of volume	m3
Package volume	0.831 m3
Package length	95
Package width	100
Package height	100
Package unit of dimension	cm
Package dimensions (LxWxH)	95x100x100 cm
Net weight	140
Net weight	140 kg
Gross weight	160
Package weight	160 kg
Unit of weight	kg
Connection power kW	26.4
Fuse Size A	43
Connection voltage V	400
Number of phases	3NPE
Frequency Hz	50
Protection rating (IP)	IPX3
Type of electrical connection	Semifixed



METOS FALCON

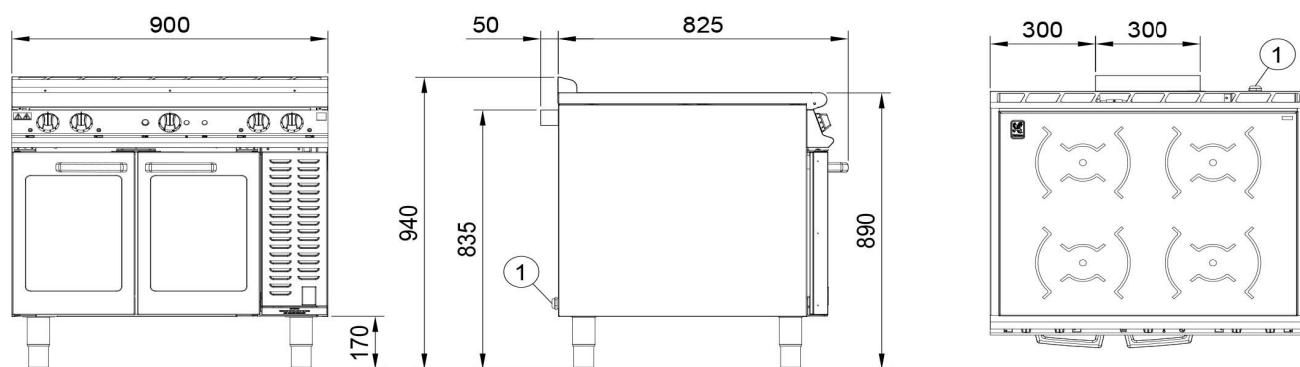

This document may not be copied in part or in whole by any process nor passed on to a third party without the written permission of the owner Metos Oy Ab.

CODE: MG4243112

Induction range Metos 8IHF4UBO/80



Technical specifications

GENERAL

Description	Induction range Metos 8IHF4UBO/80
-------------	-----------------------------------

DIMENSIONS AND CAPACITY

Item width mm	800
Item depth mm	850
Item height mm	900
Package volume	0.855 m3
Package dimensions (LxWxH)	90x95x100 cm
Net weight	65 kg
Package weight	75 kg

TECHNICAL INFORMATION

Connection power kW	20
Fuse Size A	32
Connection voltage V	400
Number of phases	3N
Type of electrical connection	Semifixed

FEATURES

Type	induction
Operation type	electromechanical
Cooking zone	4

INSTALLATION

Installation	floor model
--------------	-------------

CODE: MG4243110

Induction range Metos 8IHF2UBO/50



Technical specifications

Attachments

GENERAL

Description	Induction range Metos 8IHF2UBO/50
-------------	-----------------------------------

DIMENSIONS AND CAPACITY

Item width mm	500
Item depth mm	850
Item height mm	900
Package volume	0.57 m3
Package dimensions (LxWxH)	60x95x100 cm
Net weight	50 kg
Package weight	60 kg

TECHNICAL INFORMATION

Connection power kW	10
Fuse Size A	16
Connection voltage V	400
Number of phases	3N
Type of electrical connection	Semifixed

FEATURES

Type	induction
Operation type	electromechanical
Cooking zone	2

INSTALLATION

Installation	floor model
--------------	-------------

Induction range Metos Diamante D74/10TCI table top model, 14

The induction wok table top model Metos Diamante 70 D74/10TCI has four ceramic Ø230 mm size 3,5 kW cooking zones. . Cooking zones - in which the temperature can be regulated via control knobs - have been marked on the 6mm thick hob made of unbreakable ceramic glass. An induction range works by only transferring inductive heat from the hob directly to the cooking vessel. Heat does not accumulate within the hob; only the bottom of the pot and the food in the pot or vessel warms up. The hob around the vessels remains cold, which makes using an induction range fast and safe. Cleaning is also easy, since food does not burn onto a cold hob. In addition, the rear of the range is at an incline, which prevents splashes from flowing behind the range.

Every detail of the strong, stylish and hygienic restaurant range series Metos Diamante 70 has been planned as an efficient and functioning solution, from pre-treatment to the preparation of the food itself, without forgetting the need to easily clean the range. Diamante 70 series ranges are available as a table top model as well as with its own cupboard, as single or multiple combined units, and are suitable for use in small to mid-sized to large kitchens. Laser cut range working surfaces allow for the seamless joining together of units into cleanly connected islands or lines in places of heavy use, such as large kitchens.

- four Ø230 mm cooking zones (3.5 kW / cooking zone)
- table model
- large splash proof control knobs
- the exterior and feet are made from stainless steel
- overheating



protection

EXTRA ACCESSORIES (can be ordered separately):

- open stand
- stand with guide rails
- cupboard doors;
- cupboard doors for utensil frames;
- utensil frames; knife rack, utensil rack, spice rack frame, spice jar rack;
- drawer for the cupboard;
- cupboard with a heated bottom;
- socket;
- side panels. protection

EXTRA ACCESSORIES (can be ordered separately):

- open stand
- stand with guide rails
- cupboard doors;
- cupboard doors for utensil frames;
- utensil frames; knife rack, utensil rack, spice rack frame, spice jar rack;
- drawer for the cupboard;
- cupboard with a heated bottom;
- socket;
- side panels.

Induction range Metos Diamante D74/10TCI table top model, 14

Item width mm	800
Item depth mm	730
Item height mm	270
Package volume	1.912
Unit of volume	m3
Package volume	1.912 m3
Package length	85
Package width	75
Package height	30
Package unit of dimension	cm
Package dimensions (LxWxH)	85x75x30 cm
Net weight	57
Net weight	57 kg
Gross weight	67
Package weight	67 kg
Unit of weight	kg
Connection power kW	14
Connection voltage V	400
Number of phases	3NPE
Frequency Hz	50/60
Protection rating (IP)	X4
Model	Diamante

Induction range Metos Diamante D94/10GCII with open cupboard

The Metos Diamante D94/10GCI induction stove with a stand has four 5kW cooking plates. The cooking plates, which temperature can be adjusted from the adjustor knobs that have six settings, are marked on the unbreakable 6 mm thick ceramic table top.

When operating the induction stove, the ceramic table top frame does not heat up and the only heat exerted comes from the cooking dish used. Moreover, heat does not collect into or around the stove, only the bottom of the pan and the food inside the pan or dish heat up. Therefore, using an induction stove is quick and safe. In addition, the cleaning of the stove is also easy, as food will not burn onto the cool surface. Furthermore, the back edge is slightly tilted, which prevents splashes from dripping behind the stove.

The Metos Diamante 90 -restaurant series is designed for demanding use in professional kitchens and, thus, the appliances are extremely efficient, functional and stylish. The sturdy structure, straightforward use and easy cleanability enable more focus on preparing the food itself. The Diamante 90 -series appliances are available in either a table top version or with its own stand, individually or in combination with other appliances. The appliances are laser cut, which guarantees that they can be connected to other appliances to form a clean and stylish look.

- open stand
- four cooking plates (5 kW / cooking plate)
- for Ø120-280 mm dishes
- large adjustors protected from splashes
- frame from stainless steel
- overheating protection

ADDITIONAL



ACCESSORIES (order separately):

- stand door
- door for accessories
- accessories; knife holder, utensil holder, spice holder, bottle holder
- heating sole for stand
- wheels
- footing

- side panels ACCESSORIES (order separately):

- stand door
- door for accessories
- accessories; knife holder, utensil holder, spice holder, bottle holder
- heating sole for stand
- wheels
- footing
- side panels

Induction range Metos Diamante D94/10GCII with open cupboard

Item width mm	800
Item depth mm	900
Item height mm	870
Package volume	0.791
Unit of volume	m3
Package volume	0.791 m3
Package length	85
Package width	95
Package height	98
Package unit of dimension	cm
Package dimensions (LxWxH)	85x95x98 cm
Net weight	155
Net weight	155 kg
Gross weight	165
Package weight	165 kg
Unit of weight	kg
Connection power kW	20
Connection voltage V	400
Number of phases	3NPE
Frequency Hz	50/60
Protection rating (IP)	X4
Remarks (electrical)	3x35A
Raw material	Stainless steel
Type	induction
Operation type	electromechanical
Top material type	ceramic



CODE: MG4231110

Induction top Metos Install-Line 1x3,5 (built-in)

Built-in induction range Metos Install-Line 3500 with one cooking zone. Cannot be used unless mounted in a table!

Full description

Technical specifications

Built-in induction range Metos Install-Line 3500 with one cooking zone. Cannot be used unless mounted in a table!

- One Ceran cooking zone 320 * 320 mm, power 3.5kW
- Connection to a single phase outlet
- Simple to use - only one knob to turn
- Mimimum pot diameter 120mm
- Energy efficient
- Fast heat, short cooking times
- Easy to clean
- No pan, no heat
- Boil-dry protection
- Frame design completely made from easy-to-maintain CrNi steel
- Cut-out dimensions 356x356 mm

GENERAL

Description	Induction top Metos Install-Line 1x3,5 (built-in)
-------------	---

DIMENSIONS AND CAPACITY

Product capacity	Plate 320 x 320 mm
Item width mm	384
Item depth mm	384
Item height mm	226
Package volume	0.053 m3
Package dimensions (LxWxH)	45x45x26 cm
Net weight	8 kg
Package weight	11 kg

TECHNICAL INFORMATION

Connection power kW	3.5
Fuse Size A	16
Connection voltage V	230
Number of phases	1NPE
Frequency Hz	50
Type of electrical connection	Plug
Electrical conn. height mm	0

FEATURES

Type	induction
Cooking zone	1

INSTALLATION

Installation	drop-in
--------------	---------

Induction range Metos Install-line 2 x 5kW

Drop-in induction range, cannot be used unless mounted in a table!.

- Two cooking zones, 5 kW each
- Knobs on the short side
- Size of ceramic plate 320 * 580 mm
- Mimimum pot diameter 120mm, no pan - no heat
- Easy to clean



Induction range Metos Install-line 2 x 5kW

Item width mm	384
Item depth mm	645
Item height mm	156
Package volume	0.087
Unit of volume	m3
Package volume	0.087 m3
Package length	53.5
Package width	77
Package height	21
Package unit of dimension	cm
Package dimensions (LxWxH)	53.5x77x21 cm
Net weight	26
Net weight	26 kg
Gross weight	28
Package weight	28 kg
Unit of weight	kg
Connection power kW	10
Fuse Size A	16
Connection voltage V	400
Number of phases	3NPE
Frequency Hz	50
Type of electrical connection	Semifixed

Induction range Metos Install-line single 3,5kW

Drop-in induction range, cannot be used unless mounted in a table!.

- One cooking zone 320 * 320 mm, power 3,5kW
- Connection to a single phase outlet
- Simple to use - only one knob to turn
- Minimum pot diameter 120mm, no pan - no heat
- Easy to clean



Induction range Metos Install-line single 3,5kW

Product capacity	Plate 320 x 320 mm
Item width mm	331
Item depth mm	331
Item height mm	226
Package volume	0.056
Unit of volume	m3
Package volume	0.056 m3
Package length	45
Package width	51
Package height	24.5
Package unit of dimension	cm
Package dimensions (LxWxH)	45x51x24.5 cm
Net weight	8
Net weight	8 kg
Gross weight	12
Package weight	12 kg
Unit of weight	kg
Connection power kW	3.5
Fuse Size A	16
Connection voltage V	230
Number of phases	1NPE
Frequency Hz	50
Type of electrical connection	Plug

Induction range Metos Install-line single 5kW

Drop-in induction range, cannot be used unless mounted in a table!.

- One cooking zone 320 * 320 mm, power 5kW
- Simple to use - only one knob to turn
- Minimum pot diameter 120mm, no pan - no heat
- Easy to clean



Induction range Metos Install-line single 5kW

Product capacity	Plate 320 x 320 mm
Item width mm	331
Item depth mm	331
Item height mm	226
Package volume	0.056
Unit of volume	m3
Package volume	0.056 m3
Package length	45
Package width	51
Package height	24.5
Package unit of dimension	cm
Package dimensions (LxWxH)	45x51x24.5 cm
Net weight	12.5
Net weight	12.5 kg
Gross weight	14.5
Package weight	14.5 kg
Unit of weight	kg
Connection power kW	5
Fuse Size A	10
Connection voltage V	400
Number of phases	3NPE
Frequency Hz	50
Type of electrical connection	Semifixed

Induction range Metos Install-line 2 x 3,5kW

Drop-in induction range, cannot be used unless mounted in a table!.

- Two cooking zones, 3,5 kW each
- Knobs on the short side
- Size of ceramic plate 320 * 580 mm
- Mimimum pot diameter 120mm, no pan - no heat
- Easy to clean



Induction range Metos Install-line 2 x 3,5kW

Product capacity	Plate 320 x 580 mm
Item width mm	384
Item depth mm	644
Item height mm	155/204
Package volume	0.087
Unit of volume	m3
Package volume	0.087 m3
Package length	53.5
Package width	77
Package height	21
Package unit of dimension	cm
Package dimensions (LxWxH)	53.5x77x21 cm
Net weight	24
Net weight	24 kg
Gross weight	26
Package weight	26 kg
Unit of weight	kg
Connection power kW	7
Fuse Size A	16
Connection voltage V	400
Number of phases	3PE
Frequency Hz	50
Type of electrical connection	Semifixed
Electrical conn. height mm	0

CODE: MG4344395

Induction Range Metos Proxy 78EINT 20kW, table top model

Induction range Metos Proxy 78EINT with unbreakable glass-ceramic top. With a modern and elegant design, the Proxy70 cooking range is designed for small, medium...



Full description

Technical specifications

Attachments

Induction range Metos Proxy 78EINT with unbreakable glass-ceramic top. With a modern and elegant design, the Proxy70 cooking range is designed for small, medium and large facilities. Front control panel made of AISI304 stainless steel with Scotch Brite Finish, the front profile is designed for easy cleaning. Complete and fully configurable range. Modules can be freely placed on the bases to create the composition to suit every need. Stainless steel outer panel with Scotch Brite Finish. Installation in the compartment is quick and easy thanks to the rear technical compartment, prepared for the passage of gas/electrical/water connections. Moulded tops for robustness, reliability and hygiene.

- Table top model
- Cooking zones with 5kW power
- Supplied as standard with H80 mm feet
- Unbreakable glass-ceramic top
- Serigraphs identifying cooking zones
- Safety sensor to prevent overheating
- Power adjustable to 12 levels
- Heating by means of an inductor equipped with a device that detects the presence of the cooking vessel on the cooking zone and automatically switches the heating on/off, and a device against overheating
- Ensures the correct positioning and suitability of the pot

- Accessories (separate price):
- JC joint cover - connection of the modules by means of a dedicated element to prevent infiltration of liquid and grime between the elements
 - Neutral open stand M80
 - Door for stand

GENERAL	
Description	Induction Range Metos Proxy 78EINT 20kW, table top model
DIMENSIONS AND CAPACITY	
Item width mm	800
Item depth mm	700
Item height mm	345
Package volume	0.412 m3
Package dimensions (LxWxH)	85x85x57 cm
Net weight	47 kg
Package weight	60 kg
TECHNICAL INFORMATION	
Connection power kW	20
Fuse Size A	40
Connection voltage V	400
Number of phases	3NPE
Frequency Hz	50/60
Protection rating (IP)	X5
Type of electrical connection	Semifixed
FEATURES	
Raw material	stainless steel
Type	induction
Operation type	electromechanical
Cooking zone	4
Model	Proxy
INSTALLATION	
Installation	table model



CODE: MG4344394

Induction Range Metos Proxy 74EINT 10kW, table top model

Induction range Metos Proxy 74EINT with unbreakable glass-ceramic top. With a modern and elegant design, the Proxy70 cooking range is designed for small, medium...

Full description

Technical specifications

Attachments

Induction range Metos Proxy 74EINT with unbreakable glass-ceramic top. With a modern and elegant design, the Proxy70 cooking range is designed for small, medium and large facilities. Front control panel made of AISI304 stainless steel with Scotch Brite Finish, the front profile is designed for easy cleaning. Complete and fully configurable range. Modules can be freely placed on the bases to create the composition to suit every need. Stainless steel outer panel with Scotch Brite Finish. Installation in the compartment is quick and easy thanks to the rear technical compartment, prepared for the passage of gas/electrical/water connections. Moulded tops for robustness, reliability and hygiene.

- Table top model
- Cooking zones with 5kW power
- Supplied as standard with H80 mm feet
- Unbreakable glass-ceramic top
- Serigraphs identifying cooking zones
- Safety sensor to prevent overheating
- Power adjustable to 12 levels
- Heating by means of an inductor equipped with a device that detects the presence of the cooking vessel on the cooking zone and automatically switches the heating on/off, and a device against overheating
- Ensures the correct positioning and suitability of the pot

- Accessories (separate price):
- JC joint cover - connection of the modules by means of a dedicated element to prevent infiltration of liquid and grime between the elements
 - Neutral open stand M40
 - Door for stand M40

GENERAL

Description	Induction Range Metos Proxy 74EINT 10kW, table top model
DIMENSIONS AND CAPACITY	
Item width mm	400
Item depth mm	700
Item height mm	345
Package volume	0.206 m3
Package dimensions (LxWxH)	44x85x55 cm
Net weight	28 kg
Package weight	34 kg

TECHNICAL INFORMATION

Connection power kW	10
Connection voltage V	400
Number of phases	3NPE
Frequency Hz	50/60
Protection rating (IP)	X5
Type of electrical connection	Semifixed

FEATURES

Raw material	stainless steel
Type	induction
Operation type	electromechanical
Cooking zone	2
Model	Proxy

INSTALLATION

Installation	table model
--------------	-------------

Table top wok Metos Eco Kitchen IND-13W-3500

Table top induction wok. Stainless steel casing

- ceramic glass, opening diameter: 300 mm
- step-less regulation
- simple to use- only one knob to turn
- overheating protection
- unit dimension: 360 x 440 x 185 mm
- plug
- including one pan: 8.5 litre, opening Ø360mm, shape Ø311mm



Table top wok Metos Eco Kitchen IND-13W-3500

Item width mm	360
Item depth mm	450
Item height mm	185
Package volume	0.105
Unit of volume	m3
Package volume	0.105 m3
Package length	59
Package width	47
Package height	38
Package unit of dimension	cm
Package dimensions (LxWxH)	59x47x38 cm
Net weight	11
Net weight	11 kg
Gross weight	13
Package weight	13 kg
Unit of weight	kg
Connection power kW	3.5
Fuse Size A	15
Connection voltage V	230
Number of phases	1NPE
Frequency Hz	50
Protection rating (IP)	X3
Type of electrical connection	Plug

CODE: MG4344186

Gas wok Metos Diamante D73/10CGPW10



Technical specifications

GENERAL

Description	Gas wok Metos Diamante D73/10CGPW10
-------------	-------------------------------------

DIMENSIONS AND CAPACITY

Item width mm	600
Item depth mm	730
Item height mm	870
Package volume	0.504 m3
Package dimensions (LxWxH)	65x80x97 cm
Net weight	50 kg
Package weight	55 kg

TECHNICAL INFORMATION

Gas diameter	1/2"
--------------	------

FEATURES

Raw material	stainless steel
Type	gas
Operation type	electromechanical
Cooking zone	1
Model	Diamante

ENERGY AND CONSUMPTION

Gas consumption kW	10
--------------------	----

CODE: MG4344190

Gas wok Metos Diamante D75/10CGPW20



Technical specifications

GENERAL

Description	Gas wok Metos Diamante D75/10CGPW20
-------------	-------------------------------------

DIMENSIONS AND CAPACITY

Item width mm	1000
Item depth mm	730
Item height mm	870
Package volume	0.854 m3
Package dimensions (LxWxH)	110x80x97 cm
Net weight	60 kg
Package weight	65 kg

TECHNICAL INFORMATION

Gas diameter	1/2"
--------------	------

FEATURES

Raw material	stainless steel
Type	gas
Operation type	electromechanical
Cooking zone	2
Model	Diamante

ENERGY AND CONSUMPTION

Gas consumption kW	20
--------------------	----

Induction Wok D72/10TCIW table top model

The induction wok table top model Metos Diamante 70 D72/10TCIW has ceramic Ø230 mm size 5 kW cooking zone. Heat does not accumulate within the hob on an induction wok, only the bottom of the pot or the food in the pot or vessel warms up, which makes use of the induction wok fast and safe.

Every detail of the strong, stylish and hygienic restaurant range series Metos Diamante 70 has been planned as an efficient and functioning solution, from pre-treatment to the preparation of the food itself, without forgetting the need to easily clean the range. Diamante 70 series ranges are available as a table top model as well as with its own cupboard, as single or multiple combined units, and are suitable for use in small to mid-sized to large kitchens. Laser cut range working surfaces allow for the seamless joining together of units into cleanly connected islands or lines in places of heavy use, such as large kitchens.



- 230 mm cooking zone (5 kW)
- table model
- large splash proof control knobs
- the exterior and feet are made from stainless steel
- overheating protection

EXTRA ACCESSORIES (can be ordered separately):

- wok pan
- open stand
- stand with guide rails
- cupboard doors;
- cupboard doors for utensil frames;
- utensil frames; knife rack, utensil rack, spice rack frame, spice jar rack;
- drawer for the cupboard;
- cupboard with a heated bottom;
- socket;
- side panels.

Induction Wok D72/10TCIW table top model

Item width mm	400
Item depth mm	730
Item height mm	270
Package volume	0.108
Unit of volume	m3
Package volume	0.108 m3
Package length	45
Package width	80
Package height	30
Package unit of dimension	cm
Package dimensions (LxWxH)	45x80x30 cm
Net weight	35
Net weight	35 kg
Gross weight	40
Package weight	40 kg
Unit of weight	kg
Connection power kW	5
Connection voltage V	400
Number of phases	3NPE
Frequency Hz	50/60
Protection rating (IP)	X4
Model	Diamante

Induction Wok Meto

Diamante D72/10GCIW with open cupboard

The Metos Diamante 70 D72/10GCIW induction wok with an open cupboard has ceramic Ø230 mm size 5 kW cooking zone. Heat does not accumulate within the hob on an induction wok, only the bottom of the pot or the food in the pot or vessel warms up, which makes use of the induction wok fast and safe.

Every detail of the strong, stylish and hygienic restaurant range series Metos Diamante 70 has been planned as an efficient and functioning solution, from pre-treatment to the preparation of the food itself, without forgetting the need to easily clean the range. Diamante 70 series ranges are available as a table top model as well as with its own cupboard, as single or multiple combined units, and are suitable for use in small to mid-sized to large kitchens. Laser cut range working surfaces allow for the seamless joining together of units into cleanly connected islands or lines in places of heavy use, such as large kitchens.

- 230 mm cooking zone (5 kW)
- open cupboard
- large splash proof control knobs
- the exterior and feet are made from stainless steel
- adjustable height 850...920 mm
- overheating protection

EXTRA ACCESSORIES (can be ordered separately):

- cupboard doors;
- cupboard doors for utensil frames;
- utensil frames; knife rack, utensil rack, spice rack frame, spice jar rack;
- drawer for the cupboard;
- cupboard guide rails (6 guide rails);
- cupboard with a heated bottom;
- socket;
- side panels.



Induction Wok Meto Diamante D72/10GCIW with open cupboard

Item width mm	400
Item depth mm	730
Item height mm	870
Package volume	0.349
Unit of volume	m3
Package volume	0.349 m3
Package length	45
Package width	80
Package height	97
Package unit of dimension	cm
Package dimensions (LxWxH)	45x80x97 cm
Net weight	50
Net weight	50 kg
Gross weight	55
Package weight	55 kg
Unit of weight	kg
Connection power kW	5
Connection voltage V	400
Number of phases	3NPE
Frequency Hz	50/60
Protection rating (IP)	X4
Model	Diamante

Induction Wok Metos

Diamante D92/10TCIW table top model

The Metos Diamante D92/10TCIW table top induction wok has a ceramic Ø300 mm, 5 kW cooking plate. When operating the induction wok, the ceramic table top frame does not heat up and the only heat exerted comes from the cooking dish used. Moreover, heat does not collect into or around the wok, only the bottom of the pan and the food inside the pan or dish heat up. Therefore, using an induction wok is quick and safe.



The Metos Diamante 90 -restaurant series is designed for demanding use in professional kitchens and, thus, the appliances are extremely efficient, functional and stylish. The sturdy structure, straightforward use and easy cleanability enable more focus on preparing the food itself. The Diamante 90 -series appliances are available in either a table top version or with its own stand, individually or in combination with other appliances. The appliances are laser cut, which guarantees that they can be connected to other appliances to form a clean and stylish look.

- table top model
- Ø300 mm cooking plate (5 kW)
- large adjusters protected from splashes
- frame from stainless steel
- overheating protection

ADDITIONAL ACCESSORIES (order separately):

- wok pan
- open stand
- open stand with five guide rails
- stand door
- door for accessories
- accessories; knife holder, utensil holder, spice holder, bottle holder
- drawers for stand
- heating sole for stand
- wheels
- footing
- side panels

Induction Wok Metos Diamante D92/10TCIW table top model

Item width mm	400
Item depth mm	900
Item height mm	270
Package volume	1.582
Unit of volume	hl
Package volume	1.582 hl
Package length	45
Package width	95
Package height	37
Package unit of dimension	cm
Package dimensions (LxWxH)	45x95x37 cm
Net weight	35
Net weight	35 kg
Gross weight	45
Package weight	45 kg
Unit of weight	kg
Connection power kW	5
Connection voltage V	400
Number of phases	3NPE
Frequency Hz	50/60
Raw material	Stainless steel
Type	induction
Operation type	electromechanical

CODE: MG4343700

Gas wok Metos Diamante D93/10CGW10



Technical specifications

GENERAL

Description	Gas wok Metos Diamante D93/10CGW10
-------------	------------------------------------

DIMENSIONS AND CAPACITY

Item width mm	600
Item depth mm	900
Item height mm	870
Package volume	0.599 m3
Package dimensions (LxWxH)	65x95x97 cm
Net weight	116 kg
Package weight	126 kg

TECHNICAL INFORMATION

Gas diameter	1/2"
--------------	------

FEATURES

Raw material	stainless steel
Type	gas
Operation type	electromechanical
Cooking zone	1
Model	Diamante

ENERGY AND CONSUMPTION

Gas consumption kW	10
--------------------	----

Induction Wok Metos

Diamante D92/10GCIW with open cupboard

The Metos Diamante D92/10GCIW table top induction wok has a ceramic Ø300 mm, 5 kW cooking plate. When operating the induction wok, the ceramic table top frame does not heat up and the only heat exerted comes from the cooking dish used. Moreover, heat does not collect into or around the wok, only the bottom of the pan and the food inside the pan or dish heat up. Therefore, using an induction wok is quick and safe.

The Metos Diamante 90 -restaurant series is designed for demanding use in professional kitchens and, thus, the appliances are extremely efficient, functional and stylish. The sturdy structure, straightforward use and easy cleanability enable more focus on preparing the food itself. The Diamante 90 -series appliances are available in either a table top version or with its own stand, individually or in combination with other appliances. The appliances are laser cut, which guarantees that they can be connected to other appliances to form a clean and stylish look.

- open stand
- Ø300 mm cooking plate (5 kW)
- large adjustors protected from splashes
- frame from stainless steel
- overheating protection

ADDITIONAL ACCESSORIES (order separately):

- wok pan
- six guide rails
- stand door
- door for accessories
- accessories; knife holder, utensil holder, spice holder, bottle holder
- drawers for stand
- heating sole for stand
- wheels
- footing
- side panels



Induction Wok Metos Diamante D92/10GCIW with open cupboard

Item width mm	400
Item depth mm	900
Item height mm	870
Package volume	0.419
Unit of volume	m3
Package volume	0.419 m3
Package length	45
Package width	95
Package height	98
Package unit of dimension	cm
Package dimensions (LxWxH)	45x95x98 cm
Net weight	50
Net weight	50 kg
Gross weight	60
Package weight	60 kg
Unit of weight	kg
Connection power kW	5
Connection voltage V	400
Frequency Hz	50/60
Protection rating (IP)	X4
Raw material	Stainless steel
Type	induction
Operation type	electromechanical

CODE: MG4343704

Gas wok Metos Diamante D95/10CGW20



Technical specifications

GENERAL

Description	Gas wok Metos Diamante D95/10CGW20
-------------	------------------------------------

DIMENSIONS AND CAPACITY

Item width mm	1000
Item depth mm	900
Item height mm	870
Package volume	0.968 m3
Package dimensions (LxWxH)	105x95x97 cm
Net weight	116 kg
Package weight	126 kg

TECHNICAL INFORMATION

Gas diameter	1/2"
--------------	------

FEATURES

Raw material	stainless steel
Type	gas
Operation type	electromechanical
Cooking zone	2
Model	Diamante

ENERGY AND CONSUMPTION

Gas consumption kW	20
--------------------	----

CODE: MG4343706

Gas wok Metos Diamante D95/10CGW28



Technical specifications

GENERAL

Description	Gas wok Metos Diamante D95/10CGW28
-------------	------------------------------------

DIMENSIONS AND CAPACITY

Item width mm	1000
Item depth mm	900
Item height mm	870
Package volume	0.968 m3
Package dimensions (LxWxH)	105x95x97 cm
Net weight	116 kg
Package weight	126 kg

TECHNICAL INFORMATION

Gas diameter	1/2"
--------------	------

FEATURES

Raw material	stainless steel
Type	gas
Operation type	electromechanical
Cooking zone	2
Model	Diamante

ENERGY AND CONSUMPTION

Gas consumption kW	28
--------------------	----

CODE: MG4343702

Gas wok Metos Diamante D93/10CGW14



Technical specifications

GENERAL

Description	Gas wok Metos Diamante D93/10CGW14
-------------	------------------------------------

DIMENSIONS AND CAPACITY

Item width mm	600
Item depth mm	900
Item height mm	870
Package volume	0.599 m3
Package dimensions (LxWxH)	65x95x97 cm
Net weight	116 kg
Package weight	126 kg

TECHNICAL INFORMATION

Gas diameter	1/2"
--------------	------

FEATURES

Raw material	stainless steel
Type	gas
Operation type	electromechanical
Cooking zone	1
Model	Diamante

ENERGY AND CONSUMPTION

Gas consumption kW	14
--------------------	----

CODE: MG4344188

Gas wok Metos Diamante D73/10CGPW14



Technical specifications

Attachments

GENERAL

Description	Gas wok Metos Diamante D73/10CGPW14
-------------	-------------------------------------

DIMENSIONS AND CAPACITY

Item width mm	600
Item depth mm	730
Item height mm	870
Package volume	0.504 m3
Package dimensions (LxWxH)	65x80x97 cm
Net weight	50 kg
Package weight	55 kg

TECHNICAL INFORMATION

Gas diameter	1/2"
--------------	------

FEATURES

Raw material	stainless steel
Type	gas
Operation type	electromechanical
Cooking zone	1
Model	Diamante

ENERGY AND CONSUMPTION

Gas consumption kW	14
--------------------	----

CODE: MG4344192

Gas wok Metos Diamante D75/10CGPW28



Technical specifications

Attachments

GENERAL

Description	Gas wok Metos Diamante D75/10CGPW28
-------------	-------------------------------------

DIMENSIONS AND CAPACITY

Item width mm	1000
Item depth mm	730
Item height mm	870
Package volume	0.854 m3
Package dimensions (LxWxH)	110x80x97 cm
Net weight	60 kg
Package weight	65 kg

TECHNICAL INFORMATION

Gas diameter	1/2"
--------------	------

FEATURES

Raw material	stainless steel
Type	gas
Operation type	electromechanical
Cooking zone	2
Model	Diamante

ENERGY AND CONSUMPTION

Gas consumption kW	28
--------------------	----

Induction Wok Metos Flex

3.5

Table-top induction wok. One heating zone

- wok ceran bowl Ø300 mm
- inductor coil Ø270 mm
- 12 power levels
- one pan 5,2 liter included with the unit
- stainless steel housing
- washable housing
- height adjustable, locking, feet
- RTCSmp control/monitoring
- short heating time
- timer
- energy efficient



Induction Wok Metos Flex 3.5

Product capacity	Wok-pan volume 5,2 litres
Item width mm	380
Item depth mm	441/473
Item height mm	200
Package volume	0.06
Unit of volume	m3
Package volume	0.06 m3
Package length	40
Package width	50
Package height	30
Package unit of dimension	cm
Package dimensions (LxWxH)	40x50x30 cm
Net weight	14
Net weight	14 kg
Gross weight	16
Package weight	16 kg
Unit of weight	kg
Connection power kW	3.5
Fuse Size A	16
Connection voltage V	230
Number of phases	1PE
Frequency Hz	50/60
Electrical conn. inlet	Left;Behind

Induction Wok Metos Flex 8

Table-top induction wok. One heating zone

- wok ceran bowl Ø300 mm
- inductor coil Ø270 mm
- 12 power levels
- one pan 5,2 liter included with the unit
- stainless steel housing
- washable housing
- height adjustable, locking, feet
- RTC Smp control/monitoring
- short heating time
- timer
- energy efficient



Induction Wok Metos Flex 8

Product capacity	Wok-pan volume 5,2 litres
Item width mm	380
Item depth mm	441/473
Item height mm	200
Package volume	0.06
Unit of volume	m3
Package volume	0.06 m3
Package length	40
Package width	50
Package height	30
Package unit of dimension	cm
Package dimensions (LxWxH)	40x50x30 cm
Net weight	16
Net weight	16 kg
Gross weight	18
Package weight	18 kg
Unit of weight	kg
Connection power kW	8
Connection voltage V	400
Number of phases	3PE
Frequency Hz	50/60
Electrical conn. inlet	Left;Behind

Induction Wok Metos Flex 5

Table-top induction wok. One heating zone

- wok ceran bowl Ø300 mm
- inductor coil Ø270 mm
- 12 power levels
- one pan 5,2 liter included with the unit
- stainless steel housing
- washable housing
- height adjustable, locking, feet
- RTC Smp control/monitoring
- short heating time
- timer
- energy efficient



Induction Wok Metos Flex 5

Product capacity	Wok-pan volume 5,2 litres
Item width mm	380
Item depth mm	441/473
Item height mm	200
Package volume	0.06
Unit of volume	m3
Package volume	0.06 m3
Package length	40
Package width	50
Package height	30
Package unit of dimension	cm
Package dimensions (LxWxH)	40x50x30 cm
Net weight	16
Net weight	16 kg
Gross weight	18
Package weight	18 kg
Unit of weight	kg
Connection power kW	5
Fuse Size A	16
Connection voltage V	400
Number of phases	3PE
Frequency Hz	50/60
Electrical conn. inlet	Left;Behind

Induction wok Metos Install- line Wok 5 400V3N~

Simple to incorporate into work surface thanks to its frame design. Maximum operating safety thanks to various protection and monitoring functions

- Short cooking times
- Realtime Temperature Control System RTCS® assures compatibility with all (ferromagnetic) induction pans
- No Pan, no heat
- Energy Efficient
- Compact dimensions, low weight and easy to clean
- Cool Operations
- wok pan is not included in the delivery



Induction wok Metos Install-line Wok 5 400V3N~

Product capacity	Wok-pan volume 5l
Item width mm	384
Item depth mm	384
Item height mm	298
Package volume	0.068
Unit of volume	m3
Package volume	0.068 m3
Package length	50
Package width	45
Package height	30
Package unit of dimension	cm
Package dimensions (LxWxH)	50x45x30 cm
Net weight	14.5
Net weight	14.5 kg
Gross weight	16.5
Package weight	16.5 kg
Unit of weight	kg
Connection power kW	5
Fuse Size A	10
Connection voltage V	400
Number of phases	3NPE
Frequency Hz	50
Type of electrical connection	Semifixed

Install-line Metos Inducs Wok 3,5 230V1~

Simple built-in solution thanks to its frame design. Maximum operating safety thanks to various protection and monitoring functions

- Short cooking times
- Realtime Temperature Control System RTCS® assures compatibility with all (ferromagnetic) induction pans
- No Pan, no heat
- Energy Efficient
- Compact dimensions, low weight and easy to clean
- Cool Operations
- wok pan not included



Install-line Metos Inducs Wok 3,5 230V1~

Product capacity	Wok-pan volume 5l
Item width mm	384
Item depth mm	384
Item height mm	298
Package volume	0.069
Unit of volume	m3
Package volume	0.069 m3
Package length	51
Package width	45
Package height	30
Package unit of dimension	cm
Package dimensions (LxWxH)	51x45x30 cm
Net weight	13
Net weight	13 kg
Gross weight	15.2
Package weight	15.2 kg
Unit of weight	kg
Connection power kW	3.5
Fuse Size A	16
Connection voltage V	230
Number of phases	1N
Frequency Hz	50
Type of electrical connection	Plug
Electrical conn. height mm	0

Induction wok Metos Install- line Wok 8 400V3~

Simple to incorporate into work surface thanks to its frame design. Maximum operating safety thanks to various protection and monitoring functions

- Short cooking times
- Realtime Temperature Control System RTCS® assures compatibility with all (ferromagnetic) induction pans
- No Pan, no heat
- Energy Efficient
- Compact dimensions, low weight and easy to clean
- Cool Operations
- wok pan is not included in the delivery



Induction wok Metos Install-line Wok 8 400V3~

Product capacity	Wok-pan volume 5l
Item width mm	384
Item depth mm	384
Item height mm	298
Package volume	0.068
Unit of volume	m3
Package volume	0.068 m3
Package length	50
Package width	45
Package height	30
Package unit of dimension	cm
Package dimensions (LxWxH)	50x45x30 cm
Net weight	16
Net weight	16 kg
Gross weight	18.5
Package weight	18.5 kg
Unit of weight	kg
Connection power kW	8
Fuse Size A	12
Connection voltage V	400
Number of phases	3NPE
Frequency Hz	50
Type of electrical connection	Semifixed



По вопросам продаж и поддержки обращайтесь:

Алматы (727)345-47-04
Ангарск (3955)60-70-56
Архангельск (8182)63-90-72
Астрахань (8512)99-46-04
Барнаул (3852)73-04-60
Белгород (4722)40-23-64
Благовещенск (4162)22-76-07
Брянск (4832)59-03-52
Владивосток (423)249-28-31
Владикавказ (8672)28-90-48
Владимир (4922)49-43-18
Волгоград (844)278-03-48
Вологда (8172)26-41-59
Воронеж (473)204-51-73
Екатеринбург (343)384-55-89

Иваново (4932)77-34-06
Ижевск (3412)26-03-58
Иркутск (395)279-98-46
Казань (843)206-01-48
Калининград (4012)72-03-81
Калуга (4842)92-23-67
Кемерово (3842)65-04-62
Киров (8332)68-02-04
Коломна (4966)23-41-49
Кострома (4942)77-07-48
Краснодар (861)203-40-90
Красноярск (391)204-63-61
Курск (4712)77-13-04
Курган (3522)50-90-47
Липецк (4742)52-20-81

Магнитогорск (3519)55-03-13
Москва (495)268-04-70
Мурманск (8152)59-64-93
Набережные Челны (8552)20-53-41
Нижегород (831)429-08-12
Новокузнецк (3843)20-46-81
Ноябрьск (3496)41-32-12
Новосибирск (383)227-86-73
Омск (3812)21-46-40
Орел (4862)44-53-42
Оренбург (3532)37-68-04
Пенза (8412)22-31-16
Петрозаводск (8142)55-98-37
Псков (8112)59-10-37
Пермь (342)205-81-47

Ростов-на-Дону (863)308-18-15
Рязань (4912)46-61-64
Самара (846)206-03-16
Санкт-Петербург (812)309-46-40
Саратов (845)249-38-78
Севастополь (8692)22-31-93
Саранск (8342)22-96-24
Симферополь (3652)67-13-56
Смоленск (4812)29-41-54
Сочи (862)225-72-31
Ставрополь (8652)20-65-13
Сургут (3462)77-98-35
Сыктывкар (8212)25-95-17
Тамбов (4752)50-40-97
Тверь (4822)63-31-35

Тольятти (8482)63-91-07
Томск (3822)98-41-53
Тула (4872)33-79-87
Тюмень (3452)66-21-18
Ульяновск (8422)24-23-59
Улан-Удэ (3012)59-97-51
Уфа (347)229-48-12
Хабаровск (4212)92-98-04
Чебоксары (8352)28-53-07
Челябинск (351)202-03-61
Череповец (8202)49-02-64
Чита (3022)38-34-83
Якутск (4112)23-90-97
Ярославль (4852)69-52-93

Россия +7(495)268-04-70

Казахстан +7(727)345-47-04

Беларусь +(375)257-127-884

Узбекистан +998(71)205-18-59

Киргизия +996(312)96-26-47

эл.почта: mhi@nt-rt.ru || сайт: <http://metos.nt-rt.ru/>